



19 Whytecliffe Road South, Purley, CR8 2EZ

£1,500 PCM



# 19 Whytecliffe Road South, Purley, CR8 2EZ

£1,500 PCM



A fantastic opportunity to rent this well presented two bedroom, purpose-built apartment located on the top (fifth) floor.

The property briefly comprises a spacious entrance hall, open plan living with modern fitted kitchen area, two double bedrooms, modern bathroom suite and private front facing balcony.

By train, regular services run from Purley station to London Bridge (22 minutes), London Victoria (23 minutes), East Croydon (7 minutes) and Gatwick airport (24 minutes). There are also local bus services offering good connections to Sutton and Croydon. A short drive from Purley via the Brighton Road (A23) is Junction 7 of the M25 and Junction 8 of the M23 providing road access to Gatwick and Heathrow airports.

NCP permit parking available within one minute's walk.

Council Tax Band: C (London Borough of Croydon)  
Holding Deposit: £346



## Road Map

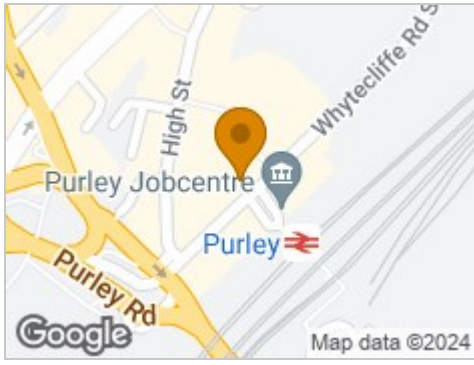

## Hybrid Map



## Terrain Map

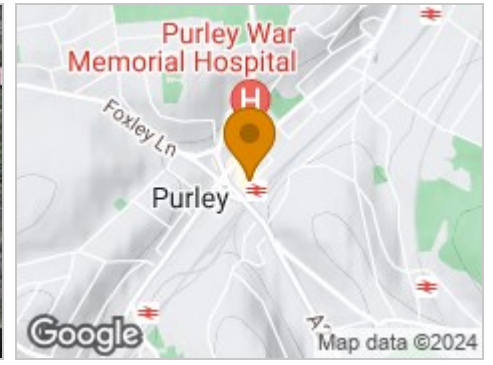

## Floor Plan

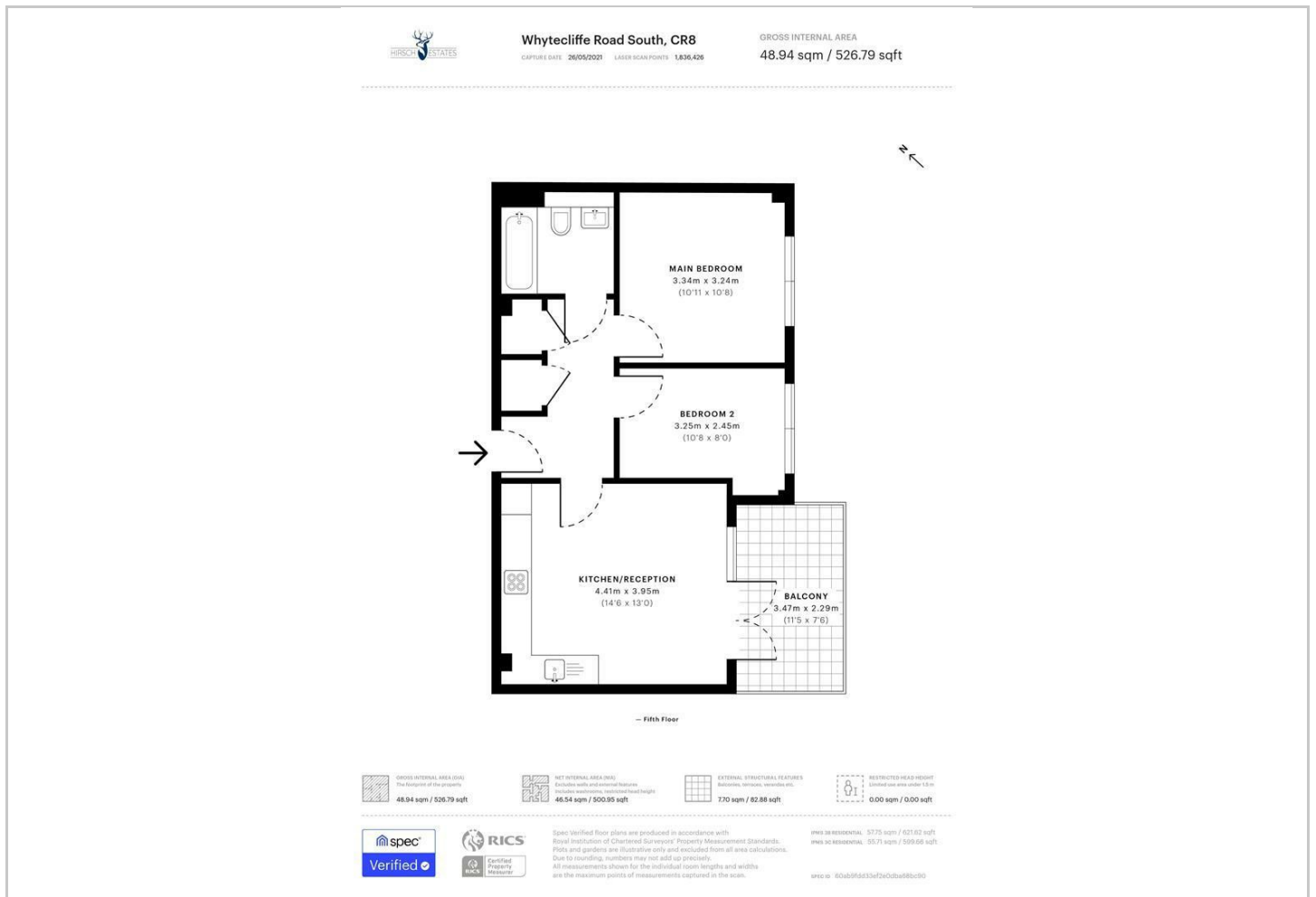

## Viewing

Please contact our Hirsch Estates Office on 020 3002 0587 if you wish to arrange a viewing appointment for this property or require further information.

## Energy Efficiency Graph

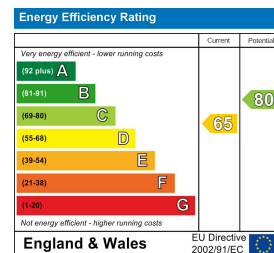

These particulars, whilst believed to be accurate are set out as a general outline only for guidance and do not constitute any part of an offer or contract. Intending purchasers should not rely on them as statements of representation of fact, but must satisfy themselves by inspection or otherwise as to their accuracy. No person in this firm's employment has the authority to make or give any representation or warranty in respect of the property.