

<https://www.fortuneandcoates.co.uk>



FORTUNE & COATES

The People's Estate Agent



FORTUNE & COATES



51 Moorfield, Harlow, CM18 7QF

Guide price £325,000

Guide Price £325,000-£350,000. Fortune and Coates are pleased to offer to the market this well presented three bedroom end of terraced family home situated in the popular location of Moorfield, Harlow which is close to local schools, shops, amenities and within easy reach of Harlow Town centre with an array of shops and supermarkets, leisure facilities, Harlow Town train station with direct links to London, Cambridge, and Stansted Airport. You are also within close proximity to the M11. The property is well maintained throughout and comprises entrance hallway with cloakroom/W.C and utility room, Kitchen to the front with range of wall and base units, spacious and bright lounge with doors to the rear garden, and separate dining room also with doors to the rear garden. Upstairs features three well proportioned bedrooms and family bathroom. Outside, the un-overlooked rear garden is lovingly maintained with a selection of shrubs and plants, lawned area and pond. This would make a fabulous family home and we would advise an early viewing. This property also has the added benefit of having a B rated EPC.

Kitchen 10'6" x 9'5" max (3.22 x 2.89 max)

Utility Room/Cloakroom

Lounge 15'7" x 12'4" (4.76 x 3.78)

Dining Room 9'8" x 11'5" (2.97 x 3.48)

Bedroom 9'4" max x 14'4" (2.87 max x 4.37)

Bedroom 12'5" max x 8'6" (3.79 max x 2.6)

Bedroom 7'8" x 8'6" (2.35 x 2.6)

Please note that these particulars do not form part of any offer or contract. All descriptions, photographs and plans are for guidance only and should not be relied upon as statements or representations of fact. All measurements are approximate.

Floor Plan

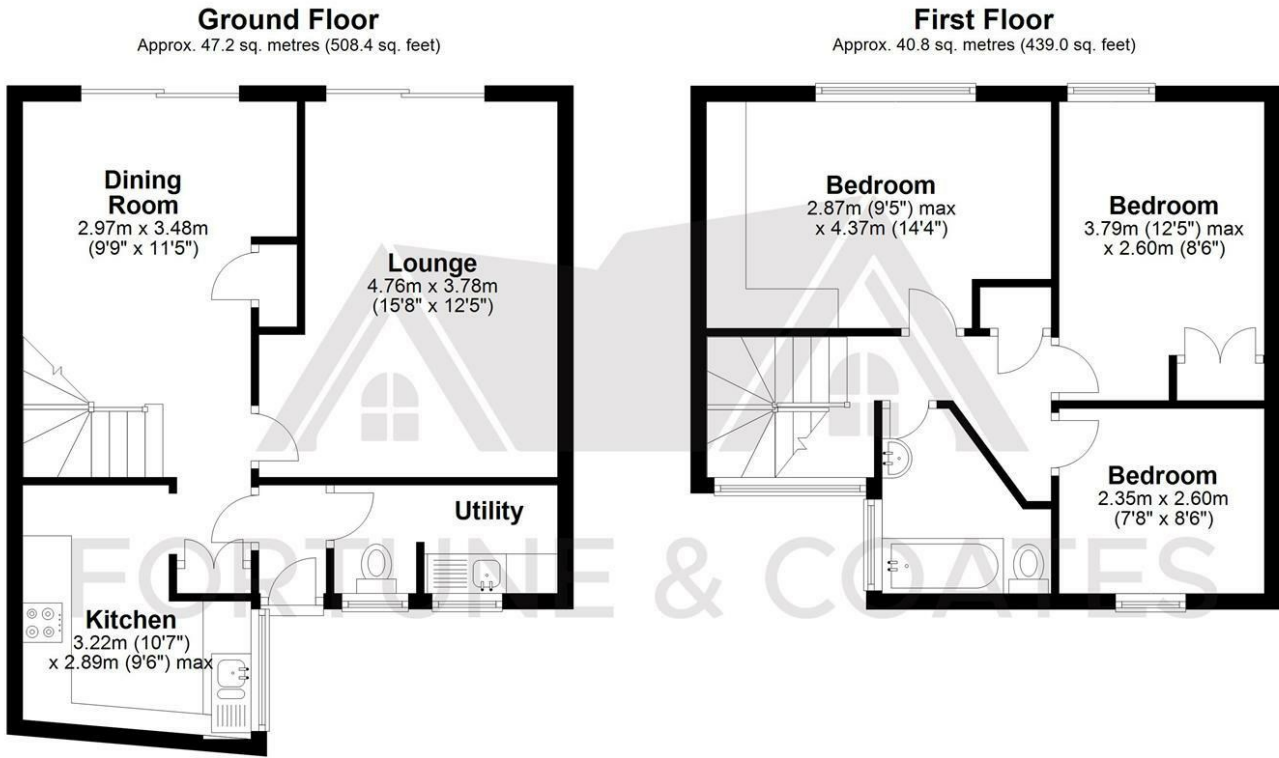

Total area: approx. 88.0 sq. metres (947.4 sq. feet)

FOR ILLUSTRATIVE PURPOSES ONLY. NOT TO SCALE. Whilst every attempt had been made to ensure the accuracy of the floor plan shown, all measurements, positioning, fixtures, features, fittings and any other data shown are an approximate interpretation for illustrative purposes only and are not to scale. No responsibility is taken for any error, omission, miss-statement or use of data shown.

Property marketing provided by www.fotomarketing.co.uk

Area Map

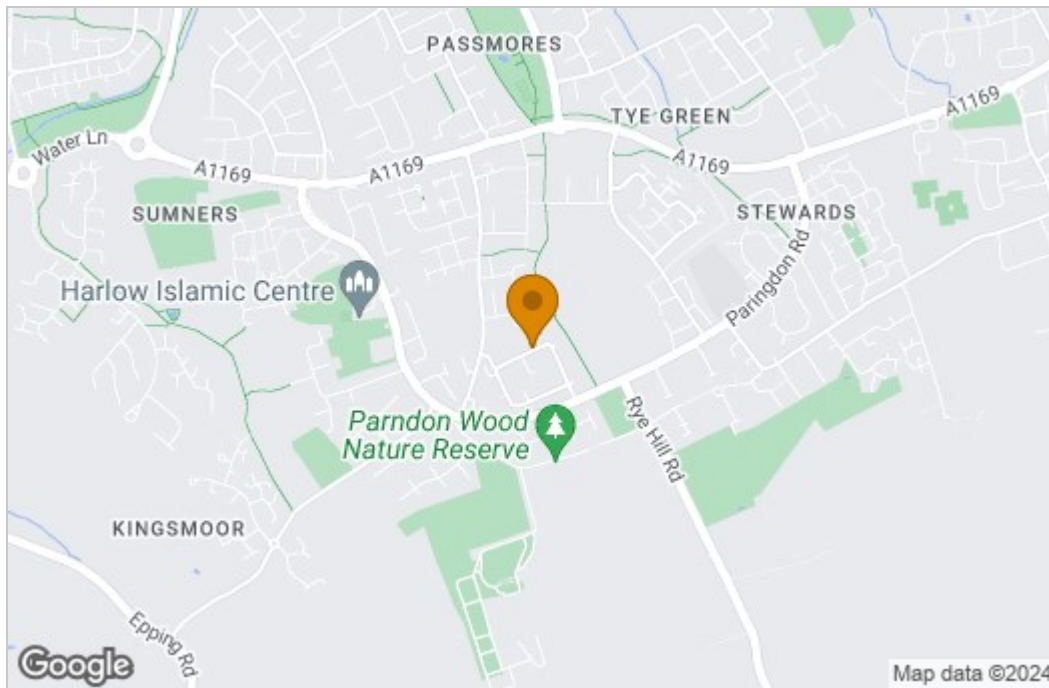

Energy Efficiency Graph

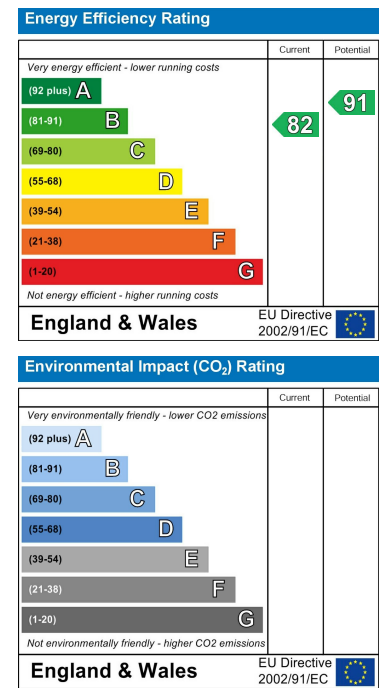

These particulars, whilst believed to be accurate are set out as a general outline only for guidance and do not constitute any part of an offer or contract. Intending purchasers should not rely on them as statements of representation of fact, but must satisfy themselves by inspection or otherwise as to their accuracy. No person in this firm's employment has the authority to make or give any representation or warranty in respect of the property.