



FORTUNE & COATES

The People's Estate Agent

<https://www.fortuneandcoates.co.uk>



FORTUNE & COATES



14 Upper Park, Harlow, CM20 1TN

Guide price £500,000

Guide Price: £500,000 - £550,000.

Fortune and Coates are delighted to offer to the market this rarely available three bedroom extended semi detached family home with potential to extend further (STPP) and is situated in the sought after location of Upper Park, Harlow which is close to junior and senior schools, amenities, Harlow town centre with an array of shops and supermarkets, Harlow Town train station with direct links to London, Cambridge and Stansted Airport and within easy reach of the M11. The property is well maintained throughout and comprises an inviting entrance hallway with cloakroom.W.C, bright and spacious lounge with french doors that lead to the dining room with access to the rear garden and the kitchen. The generous kitchen features wall and base units, utility room and access to the garage. Upstairs hosts three well proportioned bedrooms and a family bathroom complete with separate shower. Outside, the rear garden is approximately 75 feet long, un-overlooked and mainly laid to lawn with patio area for entertaining and to the front is a garage and driveway. This is a wonderful home with potential to extend to the side (STPP) and would advise an early viewing.

Lounge 21'10" x 10'0" (6.68 x 3.05)

Dining Room 11'7" x 10'0" (3.55 x 3.05)

Kitchen 20'3" x 10'0" (6.19 x 3.05)

Utility Room 6'3" x 4'0" (1.93 x 1.24)

Bedroom 11'11" x 10'11" (3.65 x 3.35)

Bedroom 11'11" x 10'4" (3.65 x 3.17)

Bedroom 9'6" x 8'4" (2.92 x 2.56)

Garage 15'2" x 12'9" (4.64 x 3.91)

Please note that these particulars do not form part of any offer or contract. All descriptions, photographs and plans are for guidance only and should not be relied upon as statements or representations of fact. All measurements are approximate.

Floor Plan

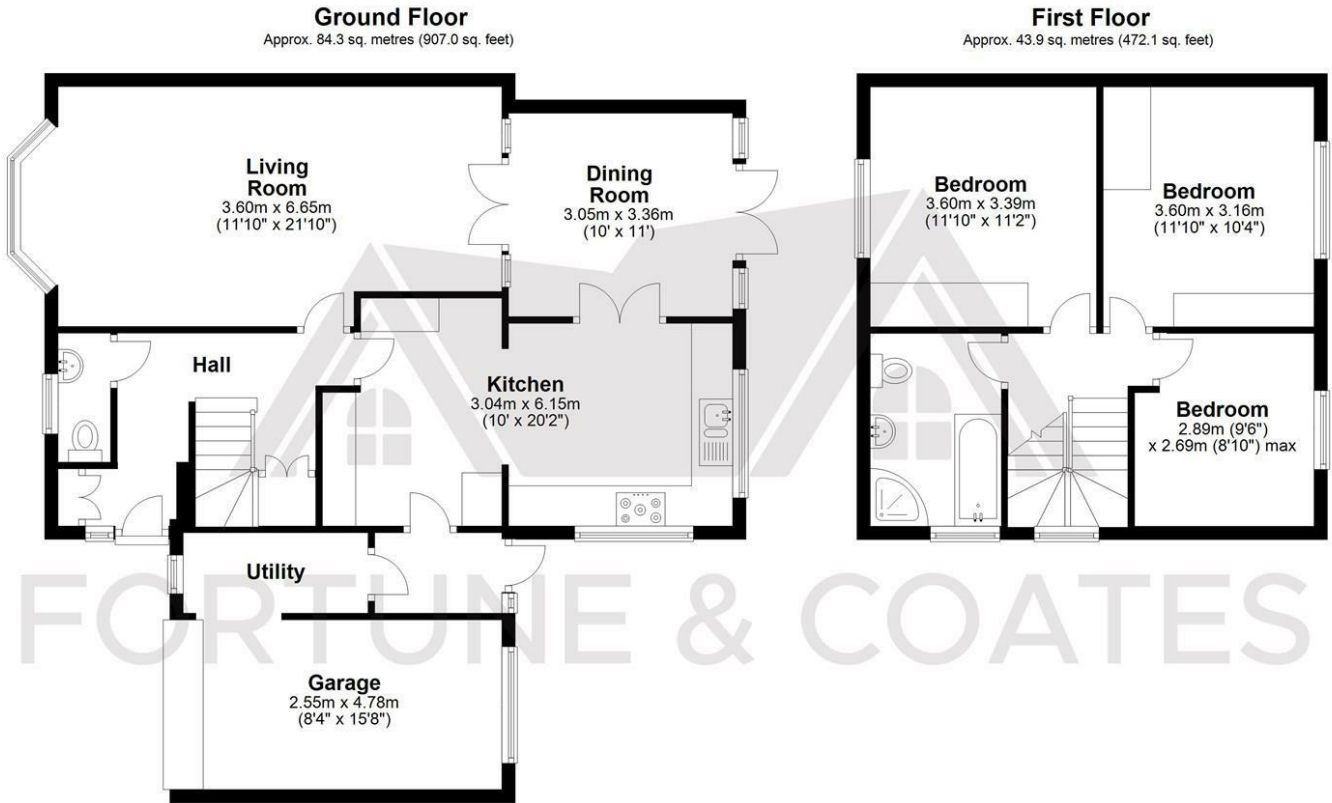

Total area: approx. 128.1 sq. metres (1379.1 sq. feet)

FOR ILLUSTRATIVE PURPOSES ONLY. NOT TO SCALE. Whilst every attempt had been made to ensure the accuracy of the floor plan shown, all measurements, positioning, fixtures, features, fittings and any other data shown are an approximate interpretation for illustrative purposes only and are not to scale. No responsibility is taken for any error, omission, miss-statement or use of data shown.

Property marketing provided by www.fotomarketing.co.uk

Area Map



Energy Efficiency Graph

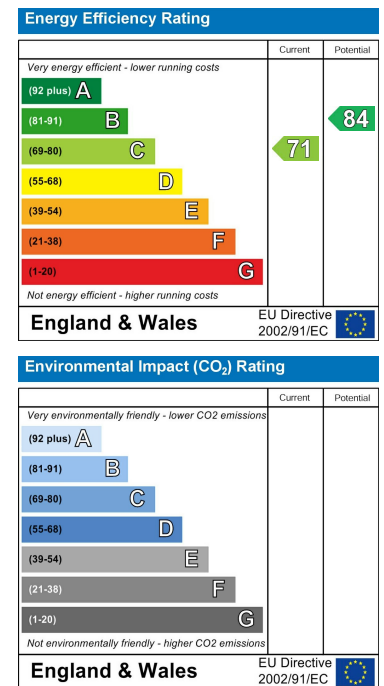

These particulars, whilst believed to be accurate are set out as a general outline only for guidance and do not constitute any part of an offer or contract. Intending purchasers should not rely on them as statements of representation of fact, but must satisfy themselves by inspection or otherwise as to their accuracy. No person in this firm's employment has the authority to make or give any representation or warranty in respect of the property.