



FORTUNE & COATES

The People's Estate Agent

<https://www.fortuneandcoates.co.uk>



FORTUNE & COATES



77a Sheering Road, Harlow, CM17 0JN

Guide price £1,100,000

Guide Price £1,100,000 - £1,200,000.

Looking for your dream home? Look no further! Step inside this magnificent and inspiring six bedroom detached family home that looks like its something from an interior design magazine situated in the sought after Sheering Road, within easy reach of local junior, senior and private schools, local amenities, shops, Train station and the new M11 7a junction. Stepping over the threshold into the welcoming entrance hallway with an abundance of natural light leading to the handmade bespoke kitchen with range of wall and base units, integrated appliances, marble work-surfaces, butler sink and double doors to the rear garden. The lounge is bright and inviting with paneling to the walls and is next to the family room which is spacious and loaded with character such as period radiators, paneling and electric feature fireplace and plenty of space for lounging and dining. Cloakroom/W.C. which is lavishly decorated. The play room offers a bay window complete with window seat and ample storage. Leading upstairs, the sweeping staircase takes you to a generous landing and six double bedrooms over two floors and features three opulent bathrooms which ooze style. Outside, the rear garden is mainly laid to lawn with decked and patio area for entertaining and has two outbuildings complete with electricity. To the front has a double garage and driveway for several cars. This home's attention to detail is outstanding with a plethora of features and an early viewing is highly advised.

Kitchen 30'8" x 11'1" (9.37 x 3.4)

Lounge 14'10" x 13'6" (4.54 x 4.13)

Family Room 24'8" x 14'2" (7.54 x 4.32)

Playroom 6'9" x 12'3" (2.07 x 3.74)

Bedroom 14'7" x 16'2" (4.47 x 4.93)

Bedroom 16'1" max x 14'2" (4.91 max x 4.32)

Bedroom 12'0" max x 10'11" (3.67 max x 3.33)

Bedroom 15'6" x 11'1" (4.74 x 3.4)

Bedroom 13'11" x 12'0" (4.25 x 3.66)

Bedroom 10'7" x 14'2" (3.24 x 4.32)

Utility 6'5" x 4'2" (1.97 x 1.28)

Please note that these particulars do not form part of any offer or contract. All descriptions, photographs and plans are for guidance only and should not be relied upon as statements or representations of fact. All measurements are approximate.

Floor Plan

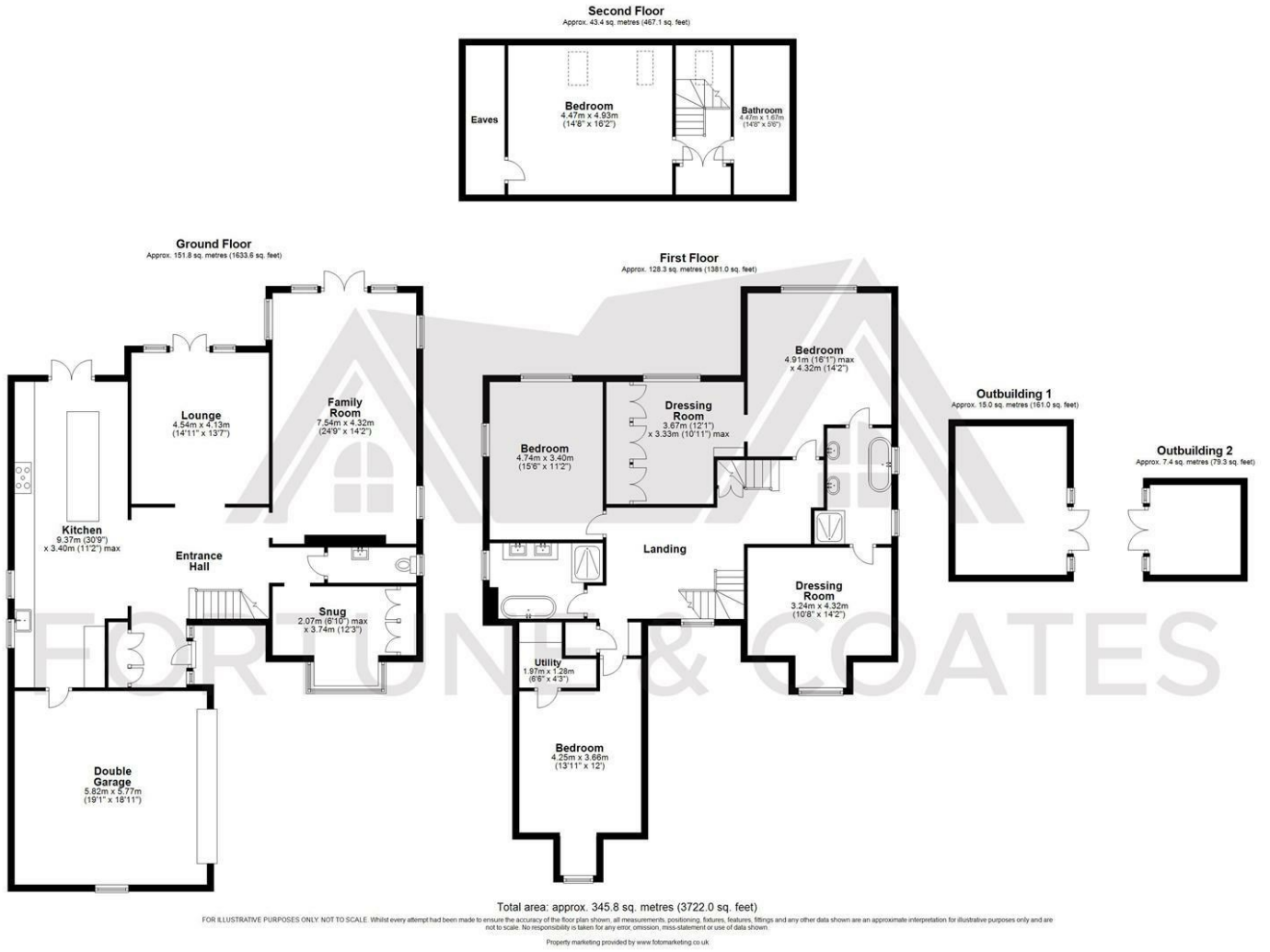

Area Map

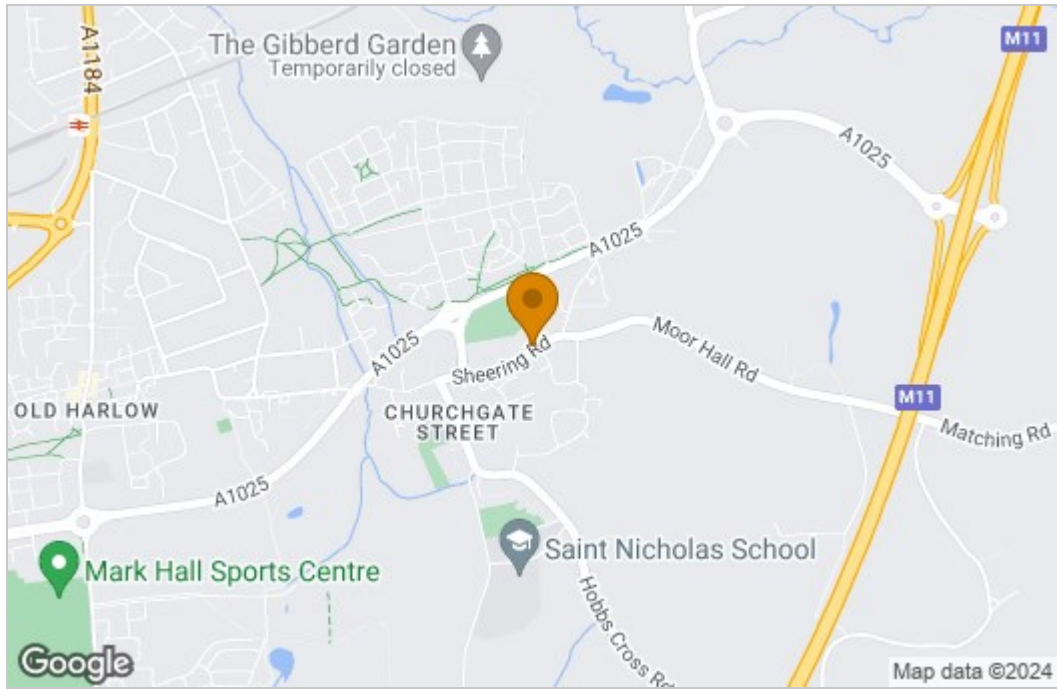

Energy Efficiency Graph

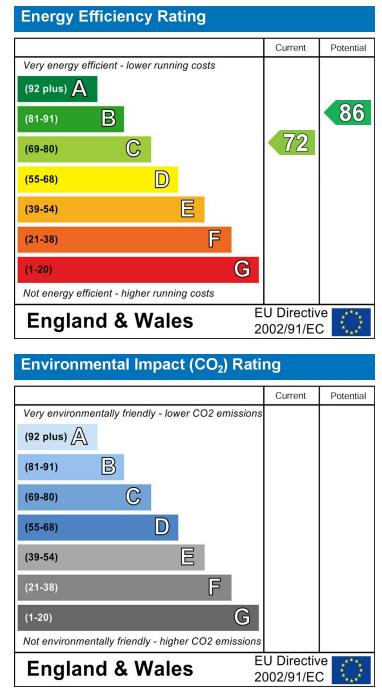

These particulars, whilst believed to be accurate are set out as a general outline only for guidance and do not constitute any part of an offer or contract. Intending purchasers should not rely on them as statements of representation of fact, but must satisfy themselves by inspection or otherwise as to their accuracy. No person in this firm's employment has the authority to make or give any representation or warranty in respect of the property.