



Beards Hill, TW12

An attractive one double bedroom, ground floor, garden flat located moments from Hampton village.

ESTATE & AGENT

— Tailored, local and personal —

Beards Hill, TW12

£339,950 Leasehold

Offered with no onward chain and vacant possession is this attractive one double bedroom, ground floor, garden flat located moments from Hampton village and close to Bushy Park.

The spacious accommodation briefly comprises: a substantial reception room, a good sized double bedroom, kitchen with wall and base units with doors leading to the rear of the property and a bathroom/w.c. with a white contemporary suite.

Externally to the rear of the property there is a private enclosed garden providing an enjoyable outside space. The property benefits from double glazing and gas fired central heating with an EPC of C.

Beards Hill is conveniently located close to a variety of local shops and amenities including Waitrose, as well as bus and train services and easy access to Royal Bushy Park and Hampton open air pool.

There is 94 years remaining on the lease and ground rent per annum is £10. Richmond Council Tax Band: C. EPC: C.

Viewing comes highly recommended.



- One double bedroom
- Private rear garden
- No onward chain
- Close to transport links
- Close to Bushy Park

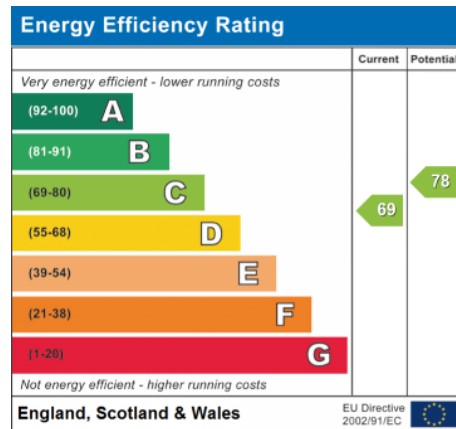



Beard's Hill, Hampton

Total Area: 37.6 m² ... 405 ft²

Viewing strictly by
appointment via
Estate and Agent

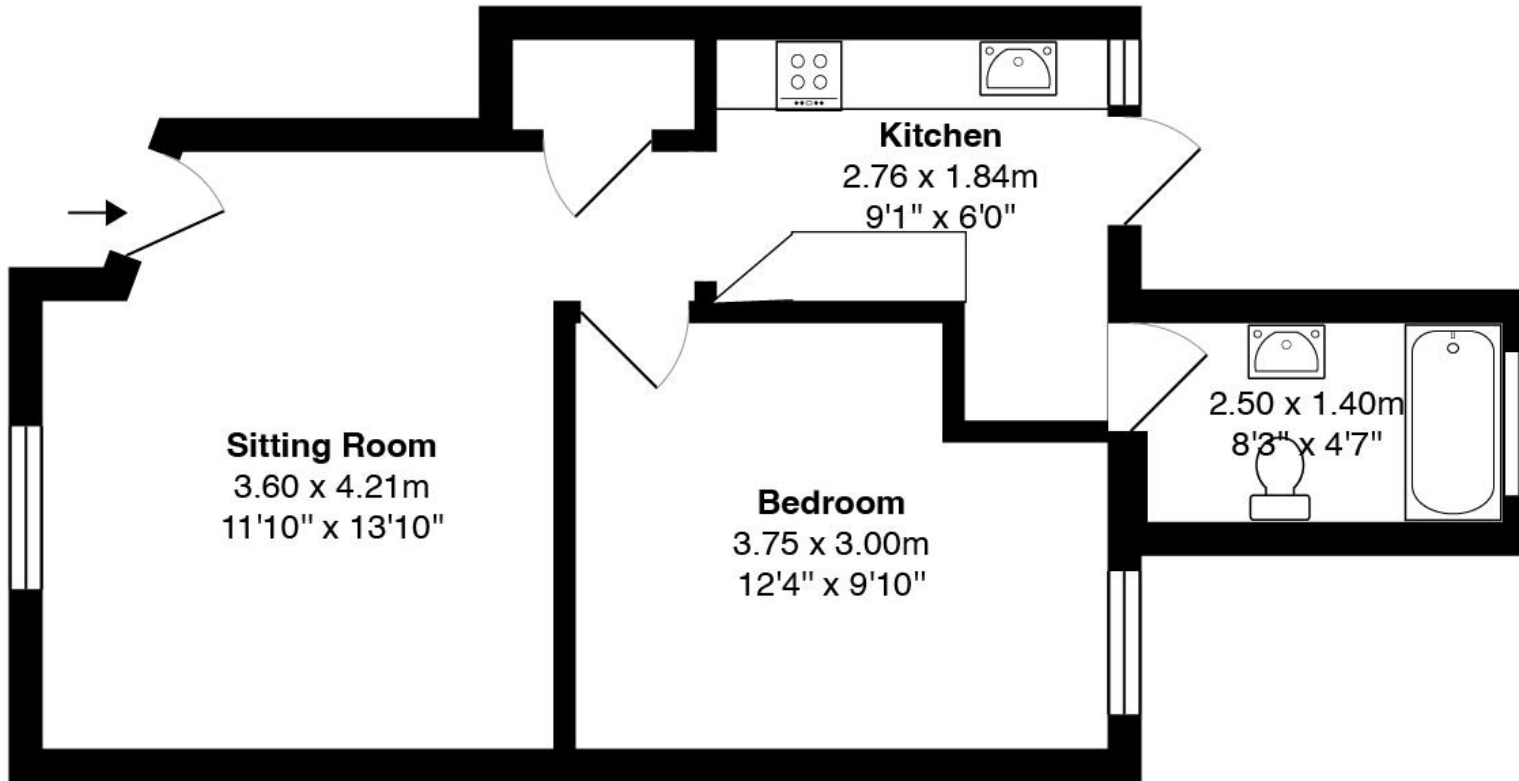

All measurements are approximate and for display purposes only

CONTACT

Estate and Agent
Hampton Wick
Kingston Upon Thames
KT1 4AY

david@estateandagent.com

Open Hours-
Monday to Friday 8am - 7pm
Saturdays 9am - 5pm
Sundays 10am - 4pm

0208 914 7884

www.estateandagent.com

Estate and Agent wish to advise prospective purchasers that we have not checked the services or appliances. The sales particulars have been prepared as guide only; any floor plan or map is for illustrative purposes only. Estates IT, for themselves and for the vendors or lessors of this property whose agents they are given that the particulars have been produced in good faith; do not constitute any part of a contract; no person in the employment of Estate & Agent has any authority to make or give any representation of warranty in relation to this property.

ESTATE & AGENT
— Tailored, local and personal —