

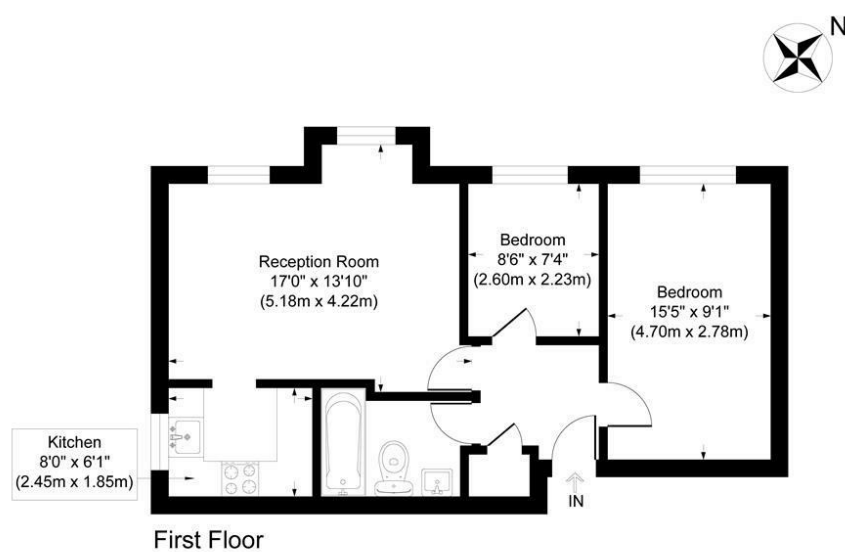

2 Bed
Flat
located in



First Floor



Camberlain Place

Approximate Gross Internal Area
Total = 53.1 sq m / 573 sq ft

This plan is for layout guidance only. Not drawn to scale unless stated. Windows and door openings are approximate. Whilst every care is taken in the preparation of this plan, please check all dimensions, shapes and compass bearings before making any decisions reliant upon them.

powered by:
THE360IMAGE
www.the360image.co.uk

Directions

Contact

125 Hoe Street
London
E17 4RX

E: lettings@hcolondon.com

T: 02085 210 755

hcolondon.com



102 Chamberlain Place

London
E17 6A7

Price Guide £325,000
Leasehold



**** Guide Price £325,000 - £350,000 ****

Humphrey and Co Estates are please to present this two bedroom purpose built apartment.
This Bright and Airy apartment compromises from charming character, Entrance hall, Spacious Lounge, separate Fitted Kitchen, two good size bedrooms and family bathroom.

Remaining years left on the lease: 155 years unexpired.
Annual Service Charge: £1520.00.
Annual Ground Rent: £210.00.

Other benefits include Eco 7 Electrical Heating, Single Glazing, and long lease. This property is ideal for first time buyers and investors. We highly recommend early viewings.

- Two Bedrooms

Summary

LONDONS LOCAL AGENT HUMPHREY & Co. ESTATES are proud to offer to the rental market this fantastic bright and airy 2 bedroom flat in a quiet private purpose built development. The property benefits from being just 10 minutes walking distance to Blackhorse Road Tube station and having both a modern fitted & bathroom as well as laminate flooring throughout. The flat offers good size living space and is in a lovely private quiet residential development.Please call our friendly lettings team to secure a viewing.

