



3 Bed
Flat
located in



Twelve Acre House Grantham Road

Approximate Gross Internal Area
Fifth Floor = 73.7 sq m / 794 sq ft

This plan is for layout guidance only. Not drawn to scale unless stated.
Windows and door openings are approximate. Whilst every care is taken
in the preparation of this plan, please check all dimensions, shapes and
compass bearings before making any decisions reliant upon them.

powered by:
THE360IMAGE
www.the360image.co.uk

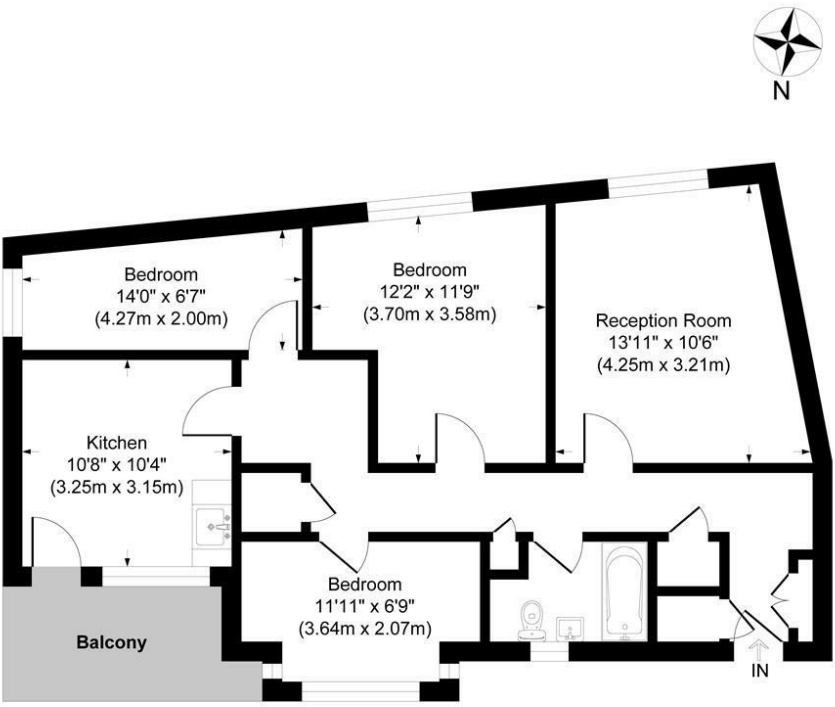

Fifth Floor

Directions

Contact

125 Hoe Street
London
E17 4RX

E: sales@hcolondon.com

T: 02085 210 755

hcolondon.com



Flat 21 Twelve
Acre House,
Grantham Road

London

Price Guide £250,000
Leasehold



****Cash Buyers Only****

Welcome to Twelve Acre House, a charming three-bedroom flat located on Grantham Road in the vibrant city of London. This delightful property offers a perfect blend of comfort and convenience, making it an ideal choice for families or professionals seeking a spacious home in a bustling urban environment.

Upon entering the flat, you will find a well-proportioned reception room that provides a warm and inviting space for relaxation and entertainment. The large windows, enhanced by double glazing, ensure that the room is filled with natural light while also providing excellent insulation against noise and the elements.

The fitted kitchen is designed with practicality in mind, offering ample storage and workspace for all your culinary needs. It is a perfect setting for preparing family meals or hosting friends. The flat features three generously sized bedrooms, each providing a peaceful retreat at the end of a busy day.

The family bathroom is conveniently located and is equipped with all the necessary amenities to cater to your daily routines. With a 104-year lease, this property offers a secure and long-term investment for potential buyers.

