



## Sycamore Close, Erdington

Birmingham, West Midlands, B24 8AQ

£159,950



**\*\* FIRST TIME BUYERS \*\* FLOOR PLAN AVAILABLE \*\*** Newton Fallowell are delighted to offer this three bedroom family home situated in a much sought after location Erdington. The property in brief comprises lounge, newly fitted kitchen, three bedrooms, two bathrooms and parking. Excellent transport links to Birmingham City Centre and surrounding areas. Call now to arrange your viewing!

#### Property Information

Three Bedroom Family Home - The property comprises in brief of three bedrooms, living room, newly fitted kitchen, family bathroom, gas central heating, double glazing and parking. For more information please give us a call!

Measurements - For room measurements please refer to the floor plans.

Viewings - Please contact Newton Fallowell Lichfield. Appointment only.

General Information - Planning Permission & Building Regulations: It is the responsibility of Purchasers to verify if any planning permission and building regulations were obtained and adhered to for any works carried out to the property.

Services - All mains services are connected to the property. However, it is advised that you confirm this at point of offer.

Other Services - Newton Fallowell - Are pleased to offer the following services:-

Residential Lettings - If you are considering renting a property or letting your property, please contact us for further information

Mortgages - If you would like advice on the best mortgages available, please contact us for further information.

Want To Sell Your Property - Call Newton Fallowell Lichfield to arrange your FREE no obligation market appraisal.

Disclaimer - These particulars are issued in good faith but do not constitute representations of fact or form part of any offer or contract. The matters referred to in these particulars should be independently verified by prospective buyers or tenants. Newton Fallowell nor any of its employees or agents has any authority to make or give any representation or warranty whatever in relation to this property.

Draft Details - PLEASE NOTE THESE ARE DRAFT DETAILS AWAITING THE VENDORS APPROVAL AND CANNOT BE RELIED ON TO BE WHOLLY ACCURATE.

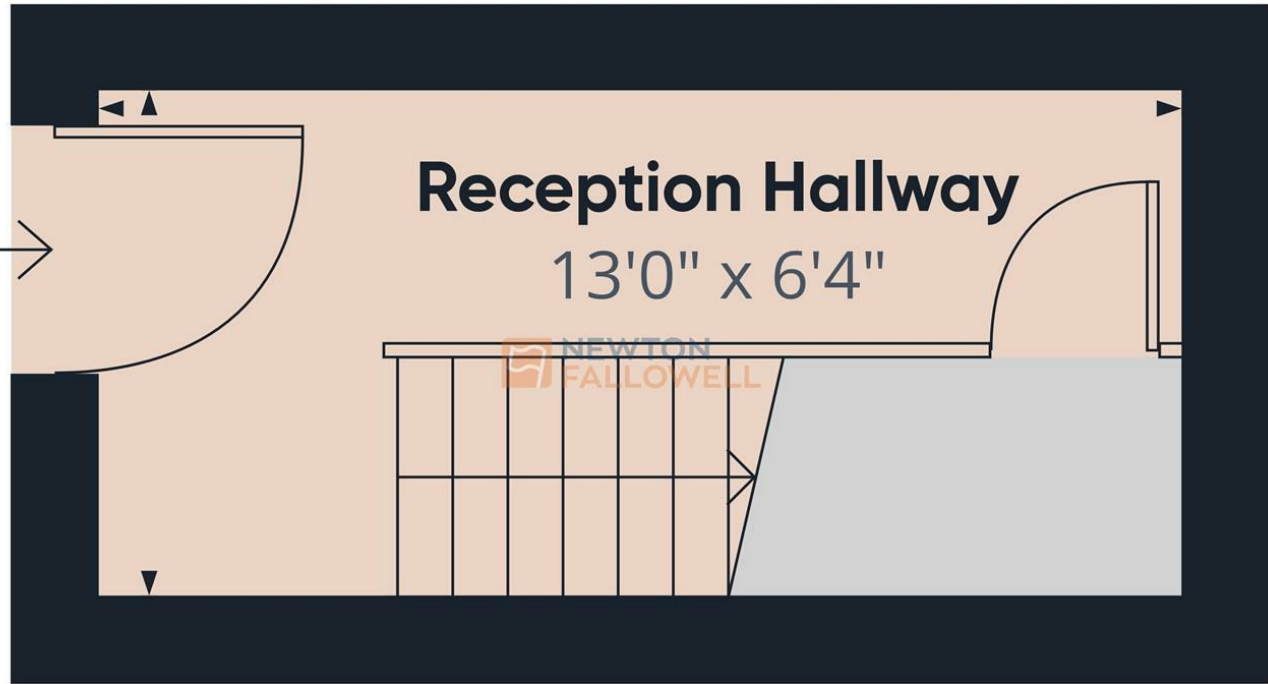

Approximate total area<sup>(1)</sup>  
88.16 ft<sup>2</sup>

(1) Excluding balconies and terraces

While every attempt has been made to ensure accuracy, all measurements are approximate, not to scale. This floor plan is for illustrative purposes only.

GIRAFFE360

Floor 0

Energy Efficiency Rating		Current	Potential
<i>Very energy efficient - lower running costs</i>			
(92 plus)	A		
(81-91)	B		
(69-80)	C		
(55-68)	D		
(39-54)	E		
(21-38)	F		
(1-20)	G		
<i>Not energy efficient - higher running costs</i>			
<b>England &amp; Wales</b>		EU Directive 2002/91/EC	

Environmental Impact (CO <sub>2</sub> ) Rating		Current	Potential
<i>Very environmentally friendly - lower CO<sub>2</sub> emissions</i>			
(92 plus)	A		
(81-91)	B		
(69-80)	C		
(55-68)	D		
(39-54)	E		
(21-38)	F		
(1-20)	G		
<i>Not environmentally friendly - higher CO<sub>2</sub> emissions</i>			
<b>England &amp; Wales</b>		EU Directive 2002/91/EC	

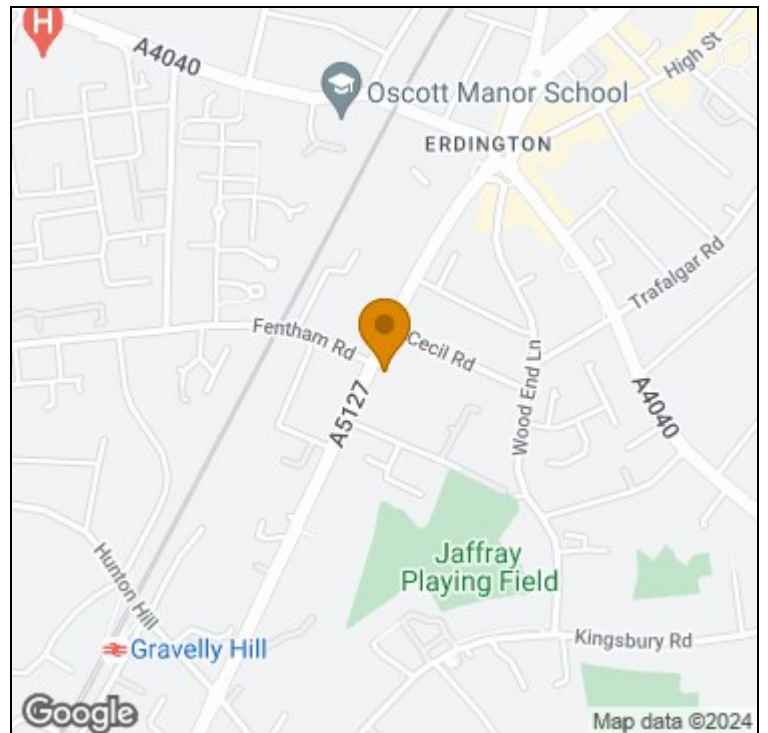

t: 01543251310 e: lichfield@newtonfallowell.co.uk

[www.newtonfallowell.co.uk](http://www.newtonfallowell.co.uk)