



173 Leeward House Discovery Road

Mount Wise, Plymouth, PL1 4PR

£1,200,000



173 Leeward House Discovery Road

Mount Wise, Plymouth, PL1 4PR

£1,200,000



LEEWARD HOUSE, MOUNT WISE, PL1 4PR

ACCOMMODATION

Front door opening into the hallway.

HALLWAY

Double doors opening to a large storage cupboard with shelving and plumbing for a washing and also housing the boiler and consumer unit. Oak flooring. Underfloor heating. Inset ceiling spotlights. Double-glazed double doors opening into the living space.

OPEN-PLAN LIVING ROOM/KITCHEN 46' x 22' max dimensions (14.02m x 6.71m max dimensions)

A stunning open-plan triple aspect south-westerly facing room to include 4 sets of bi-folding doors opening onto balconies plus the stunning outdoor terrace. From the room there are panoramic views of Plymouth, Staddon Heights, the Royal William Yard, Dartmoor, Plymouth Sound, the Tamar, Mount Edgecumbe and the Cornish coastline. There is oak flooring throughout and underfloor heating. There is a large lounge area, a dining area and a bespoke Ralph Winter fitted kitchen with a matching island. The kitchen is fitted with a range of matching cabinets and work surfaces. 2 glass breakfast bars. High-end appliances including a Gaggenau hob with an electronic extractor, built-in Gaggenau ovens and microwave plus plate warmer. Inset sink with a mixer tap and a Quooker boiling tap. Integral Gaggenau dishwasher. Integral fridge-freezer. Integral drinks fridge. Within the dining area there

is ample space for dining table and chairs and bi-folding doors to 2 elevations opening onto a balcony with LED lighting, a glass balustrade and fabulous views.

OUTSIDE TERRACE

A stunning outdoor terrace with composite decking and enclosed by a glass balustrade. Fantastic views with a south-westerly aspect.

BEDROOM ONE

15'11 x 12'2 (4.85m x 3.71m)

Full-height window with fantastic views over Plymouth towards Dartmoor. Inset ceiling spotlights. Doorway opening into the ensuite shower room.

ENSUITE SHOWER ROOM

9'8 x 5'6 (2.95m x 1.68m)

Comprising a large walk-in shower with fixed glass screen, wall-mounted controls, over-head shower plus an additional rinsing attachment, large basin with drawer storage beneath and wall-mounted wc with a concealed cistern and a push-button flush. Chrome towel rail/radiator. Wall-mounted cabinet. Recessed mirrored bathroom cabinet with integral lighting. Fully-tiled walls. Tiled floor. Inset ceiling spotlights.

BEDROOM TWO

12'2 x 11'8 (3.71m x 3.56m)

Full-height window with views over Plymouth towards Dartmoor. Inset ceiling spotlights.

FAMILY SHOWER ROOM

9'4 x 5'10 (2.84m x 1.78m)

Comprising a large walk-in shower with fixed glass screen, wall-mounted controls, over-head shower plus an additional rinsing attachment, basin with drawer storage and a wall-mounted wc with a concealed cistern and a push-button flush. Wall-mounted cabinet. Chrome towel rail/radiator. Recessed mirrored bathroom cabinet. Fully-tiled walls. Tiled floor. Inset ceiling spotlights.

OUTSIDE

3 parking spaces. Communal bike store. Communal bin store. Visitor parking bays.

AGENT'S NOTE

The property is leasehold with 985 years remaining on a 999 lease. There is an annual service charge of £4266.39 and annual ground rent of £350.

COUNCIL TAX

Plymouth City Council
Council tax band F

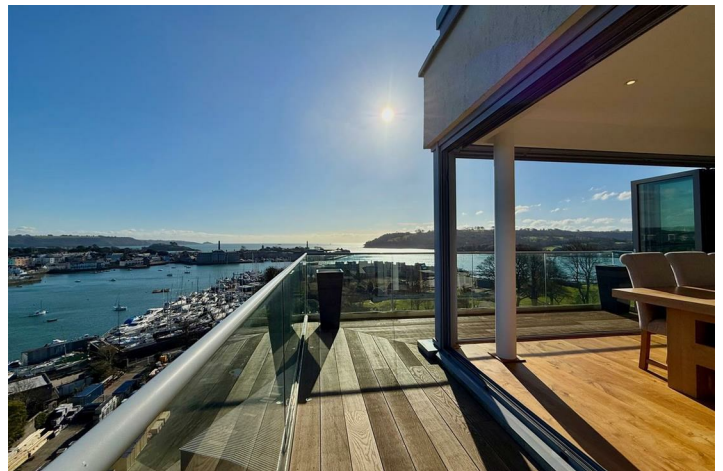

Road Map



Hybrid Map



Terrain Map



Floor Plan

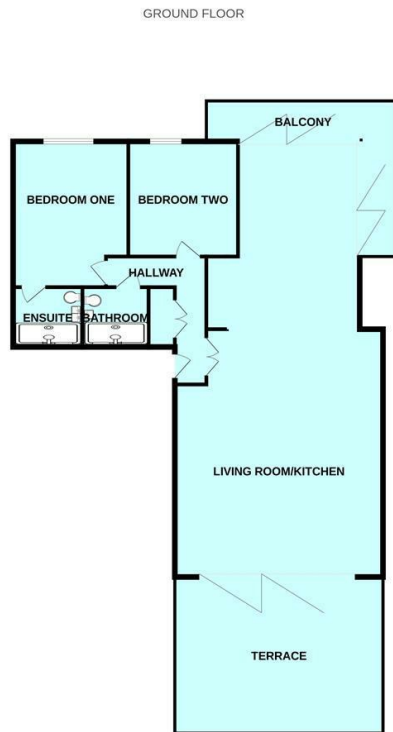

Made with Metropix ©2025

Viewing

Please contact our Plymouth Office on 01752 401128 if you wish to arrange a viewing appointment for this property or require further information.

Energy Efficiency Graph

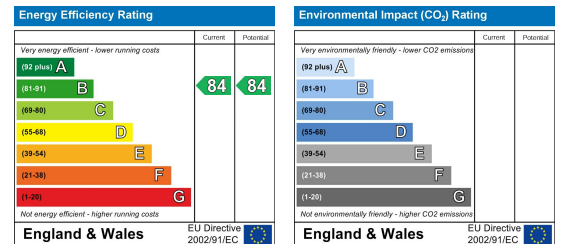

These particulars, whilst believed to be accurate are set out as a general outline only for guidance and do not constitute any part of an offer or contract. Intending purchasers should not rely on them as statements of representation of fact, but must satisfy themselves by inspection or otherwise as to their accuracy. No person in this firm's employment has the authority to make or give any representation or warranty in respect of the property.