



11 Commercial Street

Cattedown, Plymouth, PL4 0LN

£169,950



Being sold with no onward chain is this older-style character end-terraced cottage. The accommodation briefly comprises a good-sized open-plan lounge/dining area, kitchen, ground floor shower room downstairs & 2 double bedrooms on the first floor. The property has double-glazed & central heating and is located conveniently close to the centre of Plymouth.



COMMERCIAL STREET, CATTEDOWN, PL4 0LN

ACCOMMODATION

Access to the property is gained via the entrance door opening into the lounge/dining room.

LOUNGE/DINING ROOM 24'10" x 13'10" (7.57 x 4.24)

Exposed stonework to both chimney breasts. Wood-effect laminate flooring. Double-glazed window to the front elevation. Turning staircase rising to the first floor. Doorway with restricted head height leading into the kitchen.

KITCHEN 9'10" x 7'0" incl kitchen units (3.01 x 2.14 incl kitchen units)

Series of matching eye-level and base units with work surfaces. Inset sink unit. Built-in gas hob with an electric oven beneath. Space and plumbing for washing machine. Double-glazed window to the rear elevation. Part double-glazed door leading out to the rear lane. Doorway leading into a lobby area, which in turn leads to a shower room.

SHOWER ROOM 8'7" x 5'9" (2.63 x 1.77)

Comprising a Quadrant-style shower cubicle, wash basin and low level toilet. Window to the side elevation.

FIRST FLOOR LANDING

Doors providing access to the first floor accommodation.

BEDROOM ONE 14'0" x 12'11" (4.27 x 3.94)

Double-glazed window to the front elevation.

BEDROOM TWO 11'7" x 9'9" (3.54 x 2.98)

Double-glazed window to the rear elevation.

COUNCIL TAX

Plymouth City Council
Council tax band A

SERVICES

The property is connected to all the mains services: gas, electricity, water and drainage.

Area Map



Floor Plans

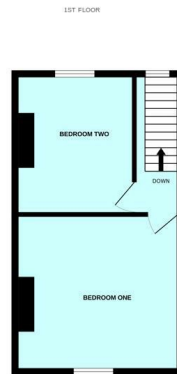
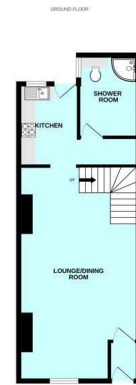

Energy Efficiency Graph

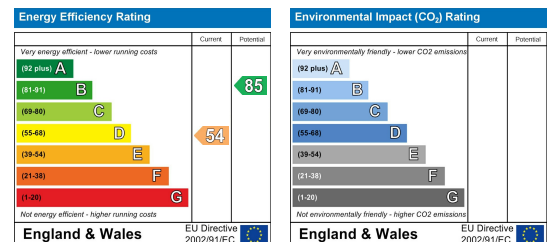

These particulars, whilst believed to be accurate are set out as a general outline only for guidance and do not constitute any part of an offer or contract. Intending purchasers should not rely on them as statements of representation of fact, but must satisfy themselves by inspection or otherwise as to their accuracy. No person in this firm's employment has the authority to make or give any representation or warranty in respect of the property.