



Winton Broad Park

Oreston, Plymouth, PL9 7QF

Price Guide £400,000



An incredible opportunity to acquire this detached property in a wonderful position within Broad Park, Oreston with lovely gardens & views including a lovely view over Hooe Lake. The property is a development/refurbishment opportunity & needs extensive work & updating. The accommodation is arranged over 2 storeys with 4 bedrooms, 4 reception rooms, 2 bathrooms & kitchen. Driveway & integral rear under garage. This really is an absolute gem. Please call us to arrange a viewing. No onward chain.

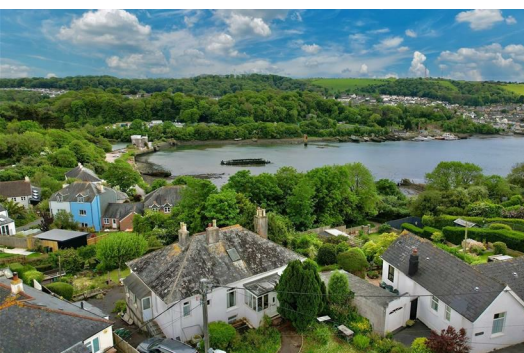

BROAD PARK, ORESTON, PL9 7QE

ACCOMMODATION

KITCHEN ROOM 12'6 x 13'2 (3.81m x 4.01m)

LIVING ROOM 13' x 12'8 (3.96m x 3.86m)

BEDROOM FOUR 12'11 x 9'9 (3.94m x 2.97m)

BEDROOM THREE 11' x 10' estimated (3.35m x 3.05m estimated)

Please note the measurements are estimated as unable to get into the room.

BATHROOM 6'8 x 5'10 estimated (2.03m x 1.78m estimated)

Please note the measurements are estimated as unable to get into the room.

FIRST FLOOR LANDING

HALL 16'10 x 6'8 (5.13m x 2.03m)

LIVING ROOM 13'6 x 8'10 (4.11m x 2.69m)

KITCHEN 10'1 x 9'9 max dimensions (3.07m x 2.97m max dimensions)

DINING ROOM 10' x 8'7 (3.05m x 2.62m)

BEDROOM ONE 13'11 x 13'5 max dimensions (4.24m x 4.09m max dimensions)

LOUNGE 13'11 x 13'10 (4.24m x 4.22m)

BEDROOM TWO 10'4 x 9'5 (3.15m x 2.87m)

BATHROOM 6'8 x 5'10 (2.03m x 1.78m)

OUTSIDE

COUNCIL TAX

Plymouth City Council
Council tax band D

Area Map



Floor Plans

GROUND FLOOR

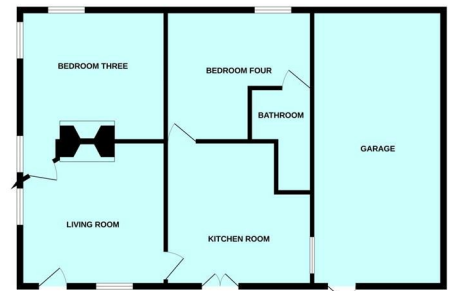

1ST FLOOR



Energy Efficiency Graph

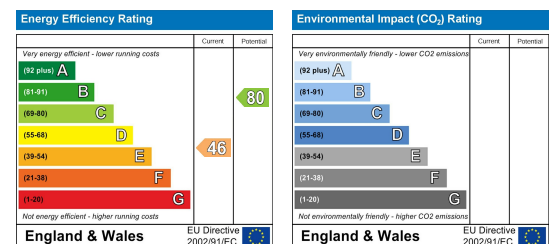

These particulars, whilst believed to be accurate are set out as a general outline only for guidance and do not constitute any part of an offer or contract. Intending purchasers should not rely on them as statements of representation of fact, but must satisfy themselves by inspection or otherwise as to their accuracy. No person in this firm's employment has the authority to make or give any representation or warranty in respect of the property.