



# PATMAN GARDENS, GILLOTT ROAD

BIRMINGHAM, B16 9LJ

£129,500  
LEASEHOLD

PATMAN GARDENS | Current AST Expires APRIL 2026 | One Bedroom | Ground Floor | Residents Parking | No Chain | CIRCA 6% NET YIELD |

# Davidson

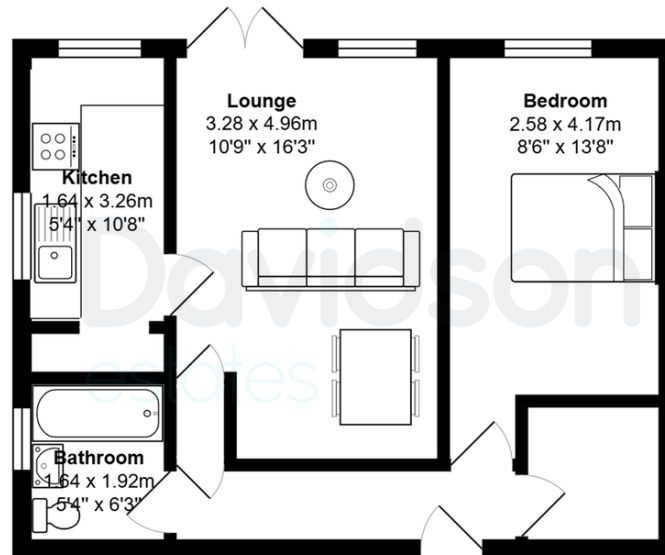
Total Area: 46.3 m<sup>2</sup> ... 498 ft<sup>2</sup>

All measurements are approximate and for display purposes only

Floorplan measurements are for illustrative purpose only. Floor plan by [www.sebastiano.co.uk](http://www.sebastiano.co.uk).

Score	Energy rating	Current	Potential
92+	A		
81-91	B		
69-80	C		75 C
55-68	D	57 D	
39-54	E		
21-38	F		

# Davidson

OFFICE  
22 Harborne Road  
Birmingham  
West Midlands  
B15 3AA

0121 455 7727  
[info@davidsonestates.co.uk](mailto:info@davidsonestates.co.uk)  
[www.davidsonestates.co.uk](http://www.davidsonestates.co.uk)

Agents Note: Whilst every care has been taken to prepare these particulars, they are for guidance purposes only. All measurements are approximate and are for general guidance purposes only and whilst every care has been taken to ensure their accuracy, they should not be relied upon and potential buyers/tenants are advised to recheck the measurements