



LINCOLN APARTMENTS, BIRMINGHAM, B15 2DS

£1,350 PCM

Lincoln Apartments | Park Central | Two bedrooms | Secure Allocated Parking |
Two bathrooms | Furnished | Third Floor | Available now | Located close to the
Birmingham City Centre and the infamous Mailbox complex

Davidson

APPROXIMATE GROSS INTERNAL AREA: 753.SQ.F / 70 SQ.M

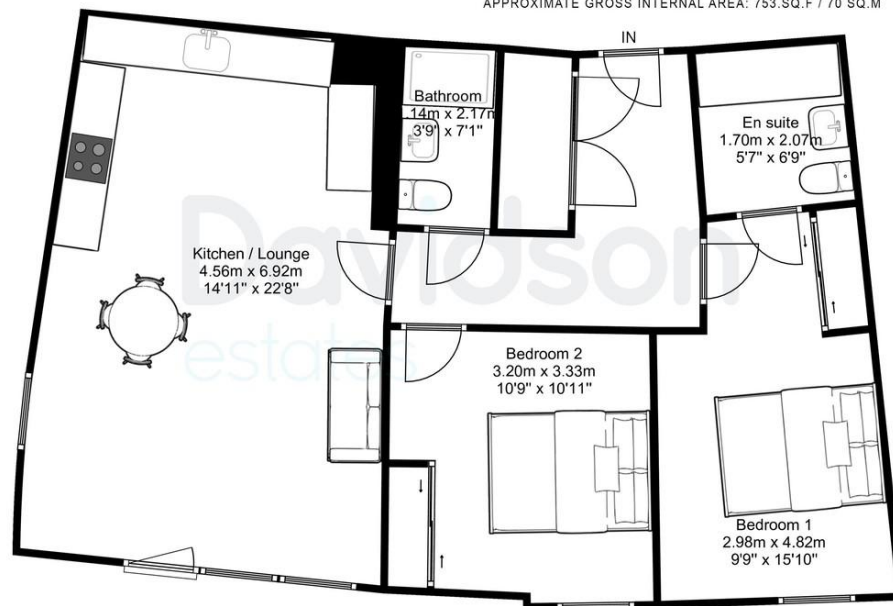

Floorplan measurements are for illustrative purpose only. Floor plan by www.sebastiano.co.uk.

Energy Efficiency Rating

Score	Energy rating	Current	Potential
92+	A		
81-91	B		
69-80	C	79 C	79 C
55-68	D		
39-54	E		

Davidson

OFFICE
14 Frederick Road
Edgbaston
Birmingham
B15 1JD

0121 455 7727
info@davidsonestates.co.uk
www.davidsonestates.co.uk

Agents Note: Whilst every care has been taken to prepare these particulars, they are for guidance purposes only. All measurements are approximate and are for general guidance purposes only and whilst every care has been taken to ensure their accuracy, they should not be relied upon and potential buyers/tenants are advised to recheck the measurements