

FOR SALE

Traditional Farm Buildings, Hall Farm, Picklescott, Church Stretton, Shropshire SY6 6NR

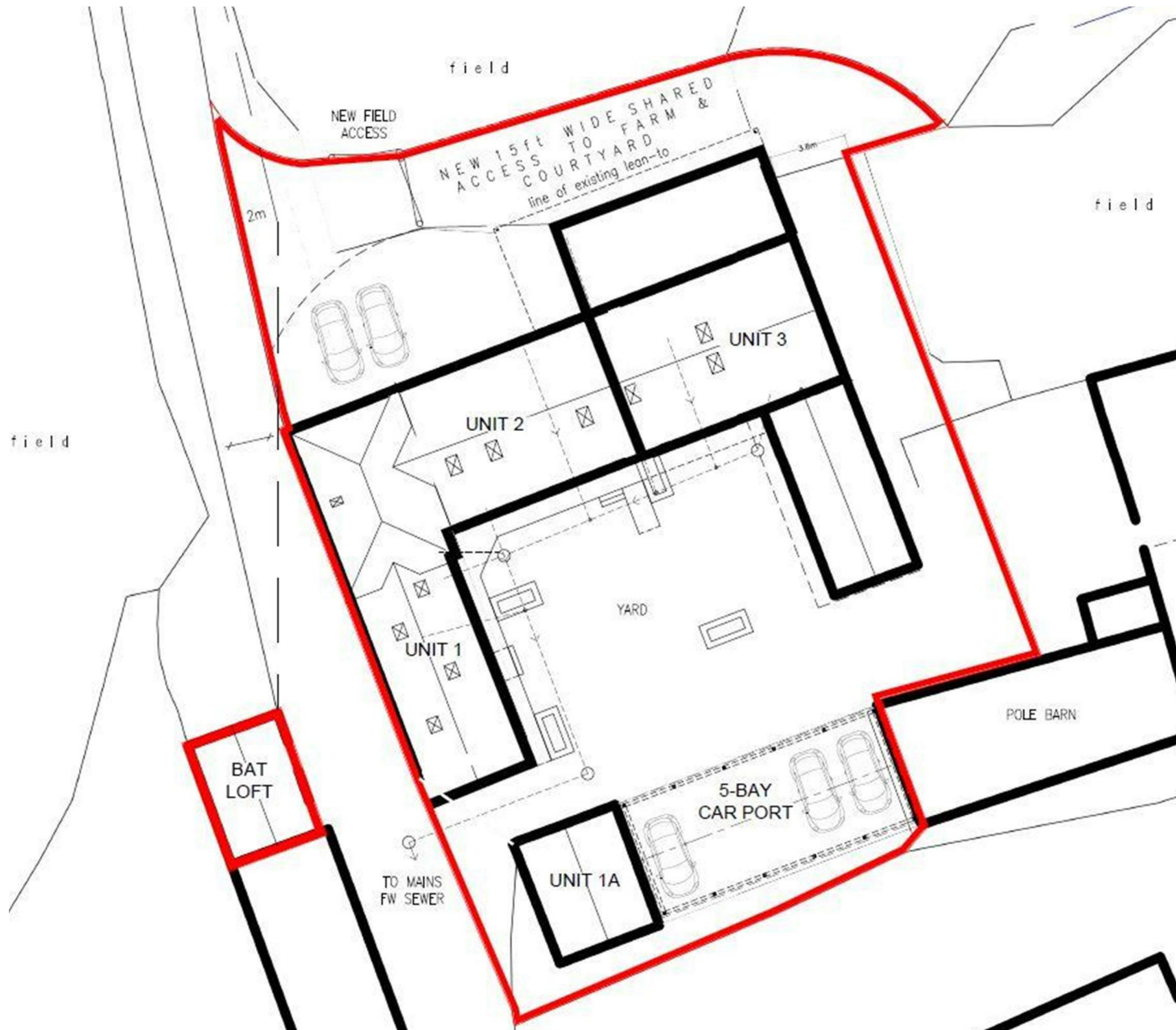

FOR SALE

Price Guide £349,000

Traditional Farm Buildings, Hall Farm, Picklescott, Church Stretton, Shropshire, SY6 6NR

Traditional farm buildings with planning permission for change of use to three residential dwellings and a 5-bay carport.



01743 450 700

Rural Professional Department
Halls Holdings Ltd, Halls Holding House, Bowmen Way, Battlefield, Shrewsbury, Shropshire, SY4 3DR
Email: reception@hallsgb.com



IMPORTANT NOTICE. Halls Holdings Ltd and any joint agents for themselves, and for the Vendor of the property whose Agents they are, give notice that: (i) These particulars are produced in good faith, are set out as a general guide only and do not constitute any part of a contract (ii) No person in the employment of or any agent of or consultant to Halls Holdings has any authority to make or give any representation or warranty whatsoever in relation to this property (iii) Measurements, areas and distances are approximate, Floor plans and photographs are for guidance purposes only (photographs are taken with a wide angled / zoom lenses) and dimensions shapes and precise locations may differ (iv) It must not be assumed that the property has all the required planning or building regulation consents. Halls Holdings, Bowmen Way, Shrewsbury, Shropshire SY4 3DR. Registered in England 06597073.

- Popular village location
- Full planning permission
- No affordable housing contribution
- Zero CIL liability
- Mains services available
- For sale by private treaty

Farm Buildings with Planning Permission

The traditional farm buildings, set in approximately 0.29 acres, comprise of a 'U' shaped range of single and two storey barns of brick and stone construction under a tiled roof. The buildings have timber framed windows and doors and are located around a central concrete yard, with access off the village road. A further small, Grade II listed, timber framed building of brick and rubble-stone construction, known as "The Bull Shed" lies separately to the main range.

Situation

Hall Farm is located on the edge of the village of Picklescott, approximately 3½ miles from Dorrington, 4½ miles from Church Stretton, and 8 miles from Shrewsbury and the A5, which connects to the M54, providing links onwards to the M5 and M6.

Planning Permission

Full planning permission and Listed Building Consent was granted in April 2018 (application references: 16/05366/FUL and 16/05367/LBC) for the conversion of the traditional agricultural buildings to create three residential dwellings, with a 5 bay carport.

Further determinations amended/varied the working of the pre-commencement conditions attached to the original planning permissions and should be read in conjunction with them.

The planning permission has been implemented by the current owners by installing the access to the proposed development and Shropshire Council has acknowledged this as a material operation to lawfully commence the development.

Affordable Housing Contribution

At the time the application was made, developments providing 5 or less dwellings in the rural area were exempt from the requirement to provide on-site affordable housing or financial contributions towards the provision of off-site affordable housing. Purchasers must satisfy themselves that this is correct.

Community Infrastructure Levy (CIL)

The CIL liability notice issued on the 8th May 2018 confirms a zero liability. A CIL Form 6 (Commencement Notice) was submitted to Shropshire Council when the development commenced, and was acknowledged.

The full suite of planning application documents can be viewed online via Shropshire Council's website.

Services

The traditional farm buildings range benefits from a three phase mains electricity connection and reservations will be made within the contract to enable them to be connected to the mains water and mains sewer network. A reservation might also be required to enable the retained farm buildings to connect into the mains services.

Rights of Way, Easements and Wayleaves

The property will be sold subject to any wayleaves, public or private rights of way, easements and covenants and all outgoings whether mentioned in these sales particulars or not.

Boundaries, Fences and Roads

The Purchaser shall be deemed to have full knowledge of the boundaries and neither the Vendors nor their Agents will be responsible for defining any ownership of boundaries, hedges or fences. They will however provide whatever assistance they can to ascertain the ownership of the same.

Local Authority

Shropshire Council, Shirehall, Abbey Foregate, Shrewsbury, SY2 6ND

Planning

The property will be sold subject to any development plan, tree preservation order, town planning schedule, resolution or notice which may be or come to be in force, subject to any road or widening or improvement schemes, land charges and statutory or provisional by-laws, without any obligation on the Vendors to specify them.

Viewings

Viewings will be accompanied and are strictly by prior appointment with the selling agents, Halls

Method of Sale

The property is for sale by Private Treaty.

Guide Price

Guide Price £349,000

Solicitor

Mr Mathew Bowering
Lanyon Bowdler Solicitors
Tel: 01743 838085

Sole Agents

David Giles/ Louise Preece
Halls Holdings Ltd
Halls Holdings House
Bowmen Way
Battlefield
Shrewsbury
Shropshire
SY4 3DR
davidg@halls.gb.com
louise@halls.gb.com
01743 450700

