



43 Main Road
Wilby, Northamptonshire

oriordanbond
SALES & LETTINGS



GROUND FLOOR

1ST FLOOR

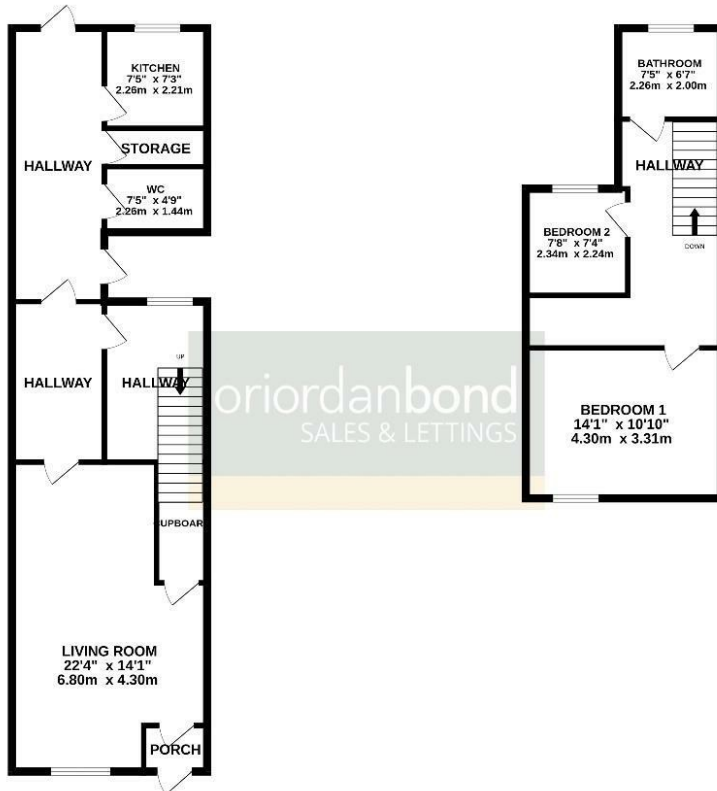

oriordanbond SALES & LETTINGS

TOTAL FLOOR AREA : 1120 sq.ft. (104.1 sq.m.) approx.

Whilst every attempt has been made to ensure the accuracy of the floorplan contained here, measurements of doors, windows, rooms and any other items are approximate and no responsibility is taken for any errors, omission or mis-statement. This plan is for illustrative purposes only and should be used as such by any prospective purchaser. The services, systems and appliances shown have not been tested and no guarantee as to their operability or efficiency can be given. www.oriordanbond.co.uk

43 Main Road

Wilby

NN8 2UB

GUIDE PRICE £200,000

A good size mature terraced property, with stunning views to the rear, located in the popular village of Wilby. This attractive property, formally part of the 'Wilby Working Mens Club', is in good order and open to change to the ground floor layout to make more usable space.

Offered for sale with no onward chain, the accommodation comprises entrance porch, spacious sitting room, inner hallway, fitted kitchen, cloakroom/WC, first floor landing, main bedroom, guest bedroom and a shower room. Outside the rear garden is southerly facing and enclosed with timber fencing, a patio area and gravelled area for easy maintenance. The property benefits from gas central heating and double glazing. (C/1120/M)

Additional information

- Council Tax Band: A
- Energy Efficiency Rating: D

Viewing

Viewing strictly by appointment – details below

Disclaimer

O'Riordan Bond Estate Agents Limited has not tested apparatus, equipment, fittings or services and so cannot verify they are in working order. The buyer is advised to obtain verification from their solicitor or surveyor.

O'Riordan Bond Earls Barton Sales

01604 810088

earlsbarton@oriordanbond.co.uk

