







## LAND FORMERLY KNOWN AS LITTLE TASKER LAND

White Gritt, Minsterley, Powys, SY5 0JN

Guide Price: £185,000

Roger Parry and Partners have been favoured with the instruction to market a block of excellent accommodation land formerly known as Little Tasker Land. The land extends to approximately 18.47 acres (7.48 ha) of grassland suitable for grazing, mowing and arable production. The land is split into two field parcels by means of a stock fence and a mature hedgerow boundary. The block is encompassed by a mature hedgerow and netting fence boundary. The property is accessed at two points; one gateway into each field parcel off the minor council road. The land benefits from a natural water supply and a livestock gathering area on the western boundary.

*Bishops Castle: 7 miles • Welshpool: 12.5 miles • Shrewsbury: 17.4 miles*

## SERVICES

Natural water supply

## METHOD OF SALE

Private Treaty

## TENURE

Freehold with vacant possession on completion.

## LOCAL AUTHORITY

Powys County Council

## WAYLEAVE, EASEMENTS AND RIGHTS OF WAY

The property is sold subject to and with the benefit of all rights including rights of way, whether public or private, light, drainage, water and electricity supplies and any other rights and obligations, easements and proposed wayleaves for masts, pylons, stays, cables, drains and water, gas and other pipes, whether referred to in the Sale details or not.

## PLANS, AREAS AND SCHEDULES

Plans are for identification and reference purposes only. The purchaser(s) shall be deemed to have satisfied themselves of the description of the property. Any error or mis-statement shall not annul a sale or entitle any party to compensation.

## AGRI-ENVIRONEMNT SCHEMES

The land is not subject to an agri-environment scheme.

## BASIC PAYMENT SCHEME

The land has been registered for the BPS. Entitlements are available by separate negotiation.

## Map of the Land

*(For illustration purposes only - not to scale)*

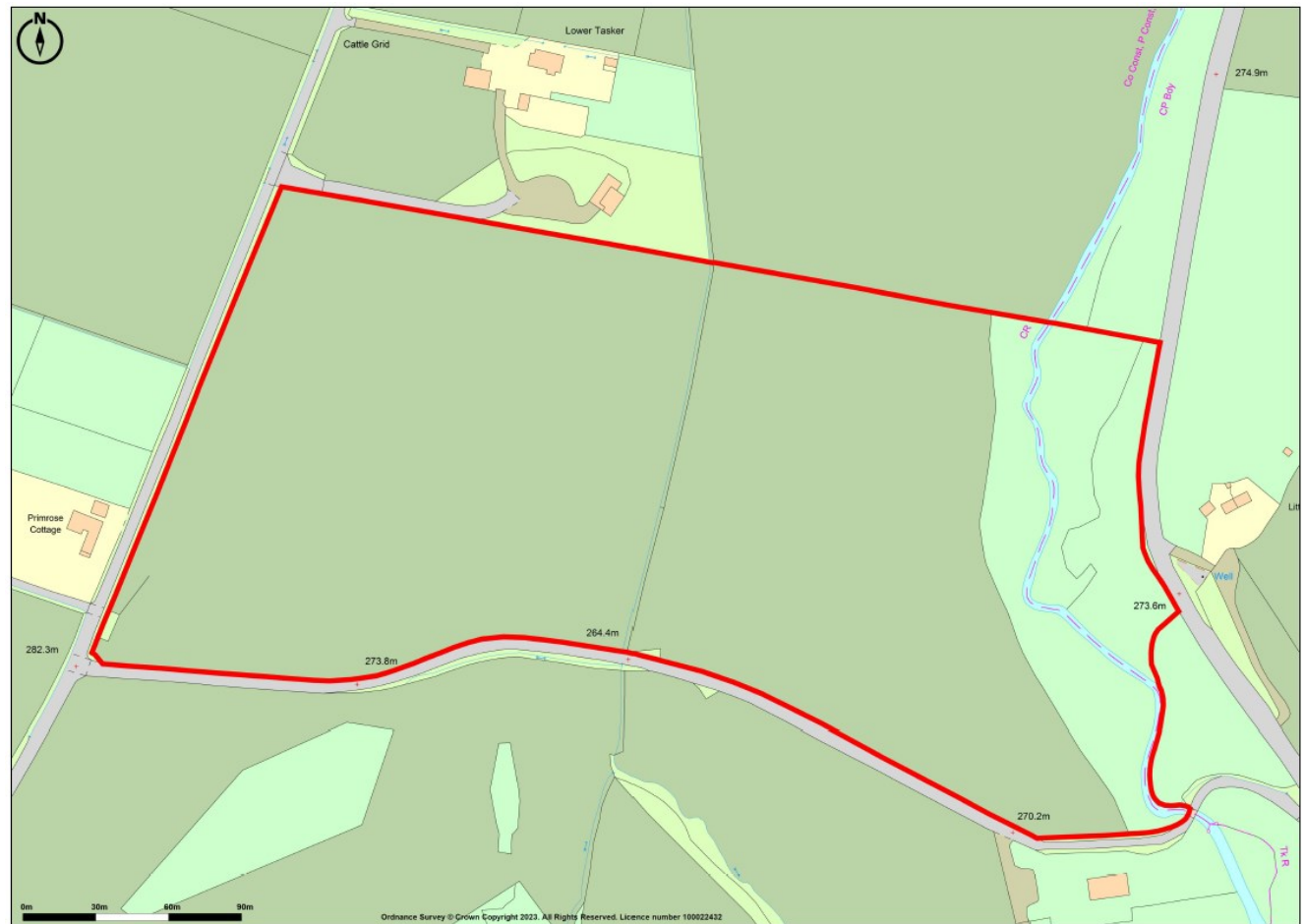



To locate the property, please  
use What3words:

///howler.asked.impeached

## Viewing arrangements

Viewing of the property is strictly by appointment only  
through

Roger Parry & Partners LLP

Please contact Tudor Watkins or Amy Thomas at

1 Berriew Street, Welshpool, SY21 7SQ

welshpool@rogerparry.net

01938 554499

**Roger  
Parry**  
& Partners

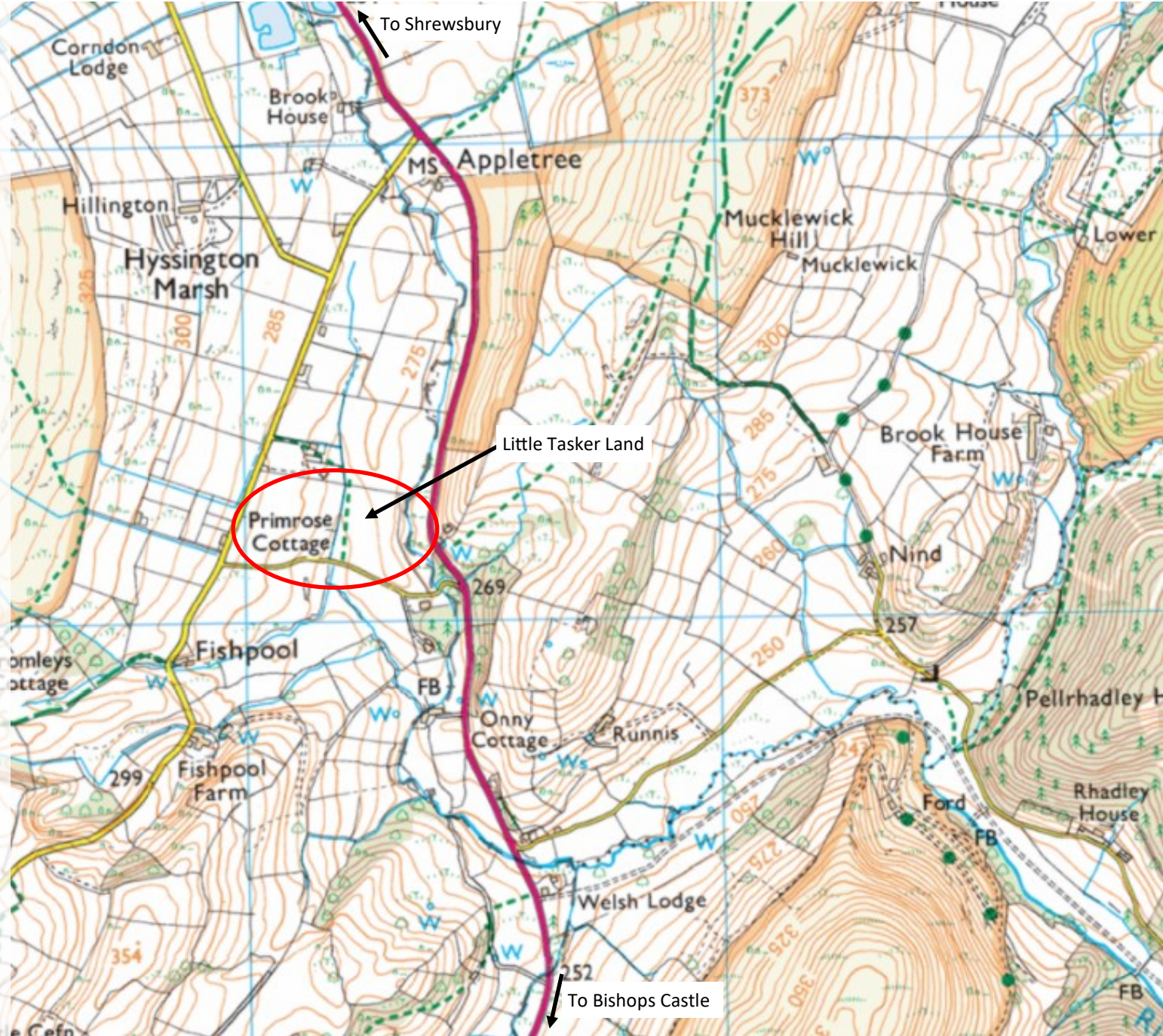

Important Notice: 1. Nothing in these particulars shall be deemed to be a statement that the property is in good structural condition or otherwise nor that any of the services, appliances, equipment or facilities are in good working order. Purchasers should satisfy themselves of this prior to purchasing. 2. Any areas, measurements, aspects or distances referred to are given as a GUIDE ONLY and are NOT precise. If such details are fundamental to a purchase, purchasers must rely on their own enquiries. 3. Descriptions of the property are subject and are used in good faith as an opinion and NOT as a statement of fact. Please make further enquiries to ensure that our description is likely to match any expectations you may have. 4. Where any references are made to planning permission or potential uses such information is given by Roger Parry & Partners in good faith. Purchasers should make their own enquiries into such matters prior to the purchase. 5. The photograph(s) depict only certain parts of the property. It should not be assumed that any contents/furniture etc. photographed are included in the sale. It should not be assumed that the property remains as displayed in photograph(s). No assumptions should be made with regards to parts of the property that have not been photographed. 6. These sale particulars have been prepared in all good faith to give a fair overall view of the property. If any points are particularly relevant to your interest in the property, please ask for further information.