



## **Bromyard Avenue, W3**

**£375,000**

A two bedroom apartment within this prestigious gated development with 24hr concierge. This second floor apartment comes with allocated off-street parking, communal gardens and a long lease.

Bromyard Avenue is located on the borders of Shepherds Bush and just over half a mile from both East Acton and Acton Central stations offering excellent access into town.

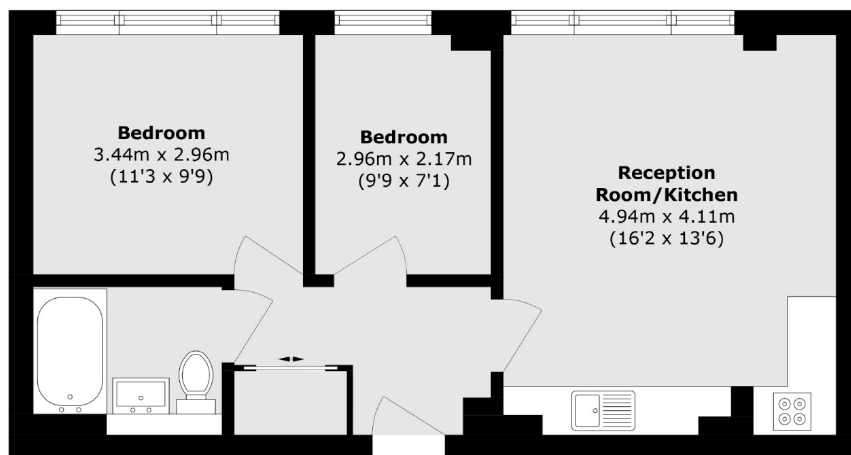

Total area (approx.): 49.0 sq. m (527.4 sq. ft)

Robertson Smith & Kempson Acton Sales  
137 High Street, Acton,  
London, W3 6LY  
020 8896 3996  
[actonsales@robertsonsmithandkempson.co.uk](mailto:actonsales@robertsonsmithandkempson.co.uk)

Energy Rating: C. We aim to make our particulars both accurate and reliable. However they are not guaranteed; nor do they form part of an offer or contract. If you require clarification on any points then please contact us, especially if you're traveling some distance to view. Please note that appliances and heating systems have not been tested and therefore no warranties can be given as to their good working order.