



Wells House Road, NW10

£461 pw (£2000 pcm)

A spacious three bedroom family home with a large private garden in an excellent location. The property has a large reception room, modern kitchen and separate WC. The upstairs bathroom benefits from underfloor heating.

Wells House Road is within easy reach of Willesden Junction and East Acton stations (Overground and Underground).

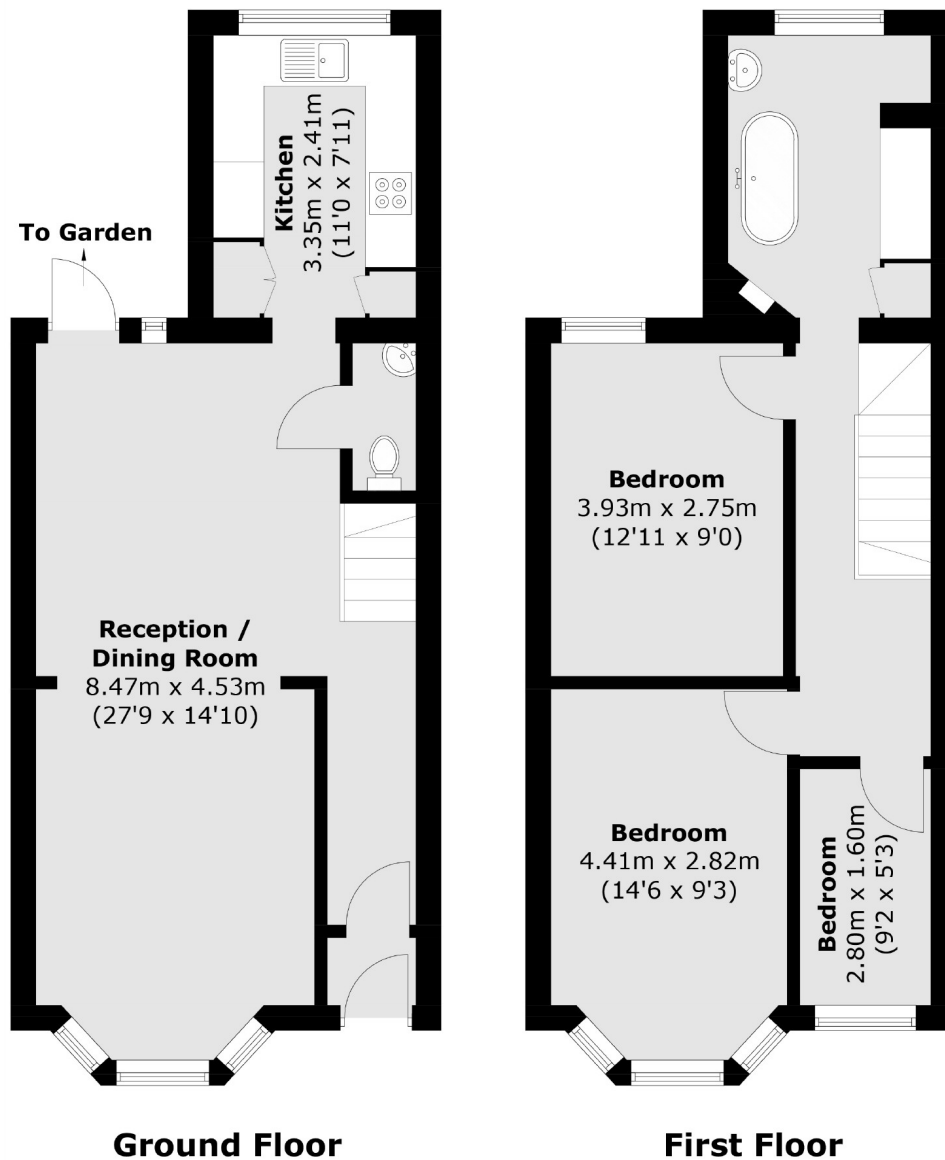

Total area (approx.): 90.7 sq. m (976.3 sq. ft)

Robertson Smith & Kempson Acton Lettings
137 High Street, Acton, London,
W3 6LY
020 8896 3967
actonlettings@robertsonsmithandkempson.co.uk

Energy Rating: D. We aim to make our particulars both accurate and reliable. However they are not guaranteed; nor do they form part of an offer or contract. If you require clarification on any points then please contact us, especially if you're traveling some distance to view. Please note that appliances and heating systems have not been tested and therefore no warranties can be given as to their good working order.