



Mill Hill Road, W3

£1,150,000

A semi-detached three bedroom family home within the Mill Hill Conservation area. The property is in excellent condition throughout and has a large south facing garden with a summer house.



This striking period property consists of a double reception room with feature fireplace and original floorboards. The rear has been extended to create a spacious open plan kitchen and dining room with doors opening out onto the stunning south facing garden. Upstairs are three bedrooms and a family bathroom.

Centrally located in the popular Mill Hill Park conservation area the house is also located close to a number of excellent local schools including the popular Ark Academy.

Mill Hill Road is within half a mile of both Acton Town and South Acton stations offering convenient access into town.

- Three Bedrooms • One Bathroom • South Facing Garden •
- Semi-Detached • Close To Station • Mill Hill Conservation Area •



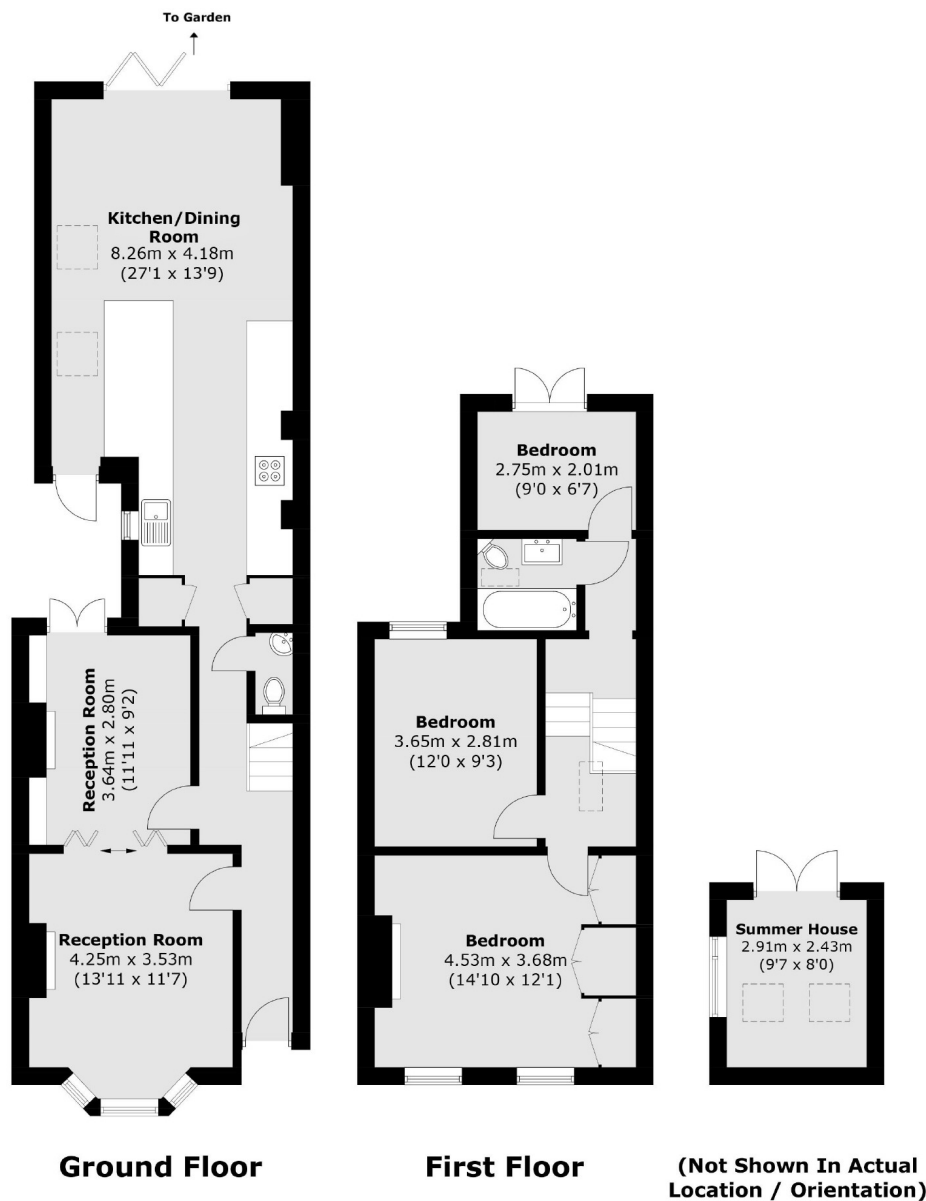

Total area (approx.): 114.3 sq. m (1,230.3 sq. ft)
Outbuilding : 7.3 sq. m (78.6 sq. ft)

Robertson Smith & Kempson Acton Sales
137 High Street, Acton,
London, W3 6LY
020 8896 3996
actonsales@robertsonsmithandkempson.co.uk

Energy Rating: D. We aim to make our particulars both accurate and reliable. However they are not guaranteed; nor do they form part of an offer or contract. If you require clarification on any points then please contact us, especially if you're traveling some distance to view. Please note that appliances and heating systems have not been tested and therefore no warranties can be given as to their good working order.