



## **The Crescent, W3**

**£1,400,000**

A spacious semi-detached five bedroom family home offering in excess of 2100 sq.ft of accommodation. The property has off-street parking for multiple cars and a large garden that has a separate home office/studio at the rear.

The Crescent is located within half a mile of Acton Main Line (Elizabeth line) and East Acton (Central line) stations. The A40 also provides easy access into and out of town.

- Five Bedrooms • Three Bathrooms • Off-Street Parking •
- Large Garden • Home Office/Studio • Semi-Detached •

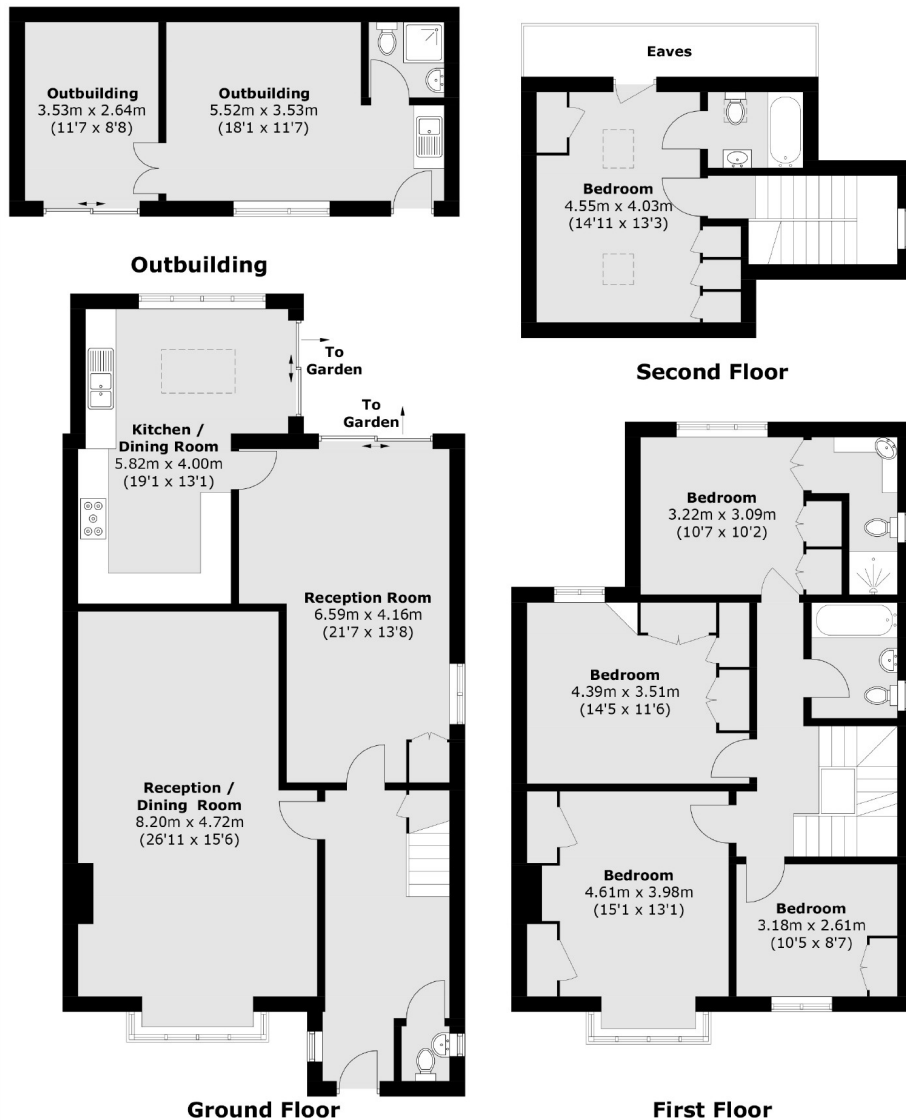

Total area (approx.): 197.0 sq. m (2,120.5 sq. ft)  
 Outbuilding area (approx.): 29.6 sq. m (318.6 sq. ft)

Robertson Smith & Kempson Hanwell Sales  
 69 Greenford Avenue,  
 London, W7 1LL  
 020 8566 2339  
[hanwellsales@robertsonsmithandkempson.co.uk](mailto:hanwellsales@robertsonsmithandkempson.co.uk)

Energy Rating: D. We aim to make our particulars both accurate and reliable. However they are not guaranteed; nor do they form part of an offer or contract. If you require clarification on any points then please contact us, especially if you're traveling some distance to view. Please note that appliances and heating systems have not been tested and therefore no warranties can be given as to their good working order.