



Inglis Road, W5

£545,000

A two bedroom period conversion garden flat situated in this imposing detached property moments from Ealing Common. The property comes with off street parking and has a share of the freehold.

Inglis Road is within half a mile of Ealing Common, Ealing Broadway (Elizabeth Line) and North Ealing stations all of which provide excellent access into town.

Ground Floor

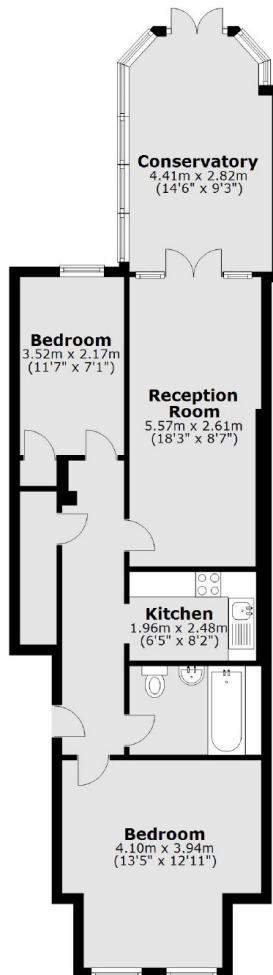

Total area: approx. 70.8 sq. metres (761.7 sq. feet)

Robertson Smith & Kempson Acton Sales
137 High Street, Acton,
London, W3 6LY
020 8896 3996
actonsales@robertsonsmithandkempson.co.uk

Energy Rating: D. We aim to make our particulars both accurate and reliable. However they are not guaranteed; nor do they form part of an offer or contract. If you require clarification on any points then please contact us, especially if you're traveling some distance to view. Please note that appliances and heating systems have not been tested and therefore no warranties can be given as to their good working order.