



## Newton Avenue, W3

£675,000

A split-level three bedroom period conversion apartment on the borders of Chiswick. The property offers almost 1000 sq.ft of accommodation, has a private balcony, share of the freehold and is offered with no onward chain.

Newton Avenue is moments from the Ofsted outstanding Ark Priory primary school and within half a mile of both South Acton and Acton Town stations offering excellent access into town.

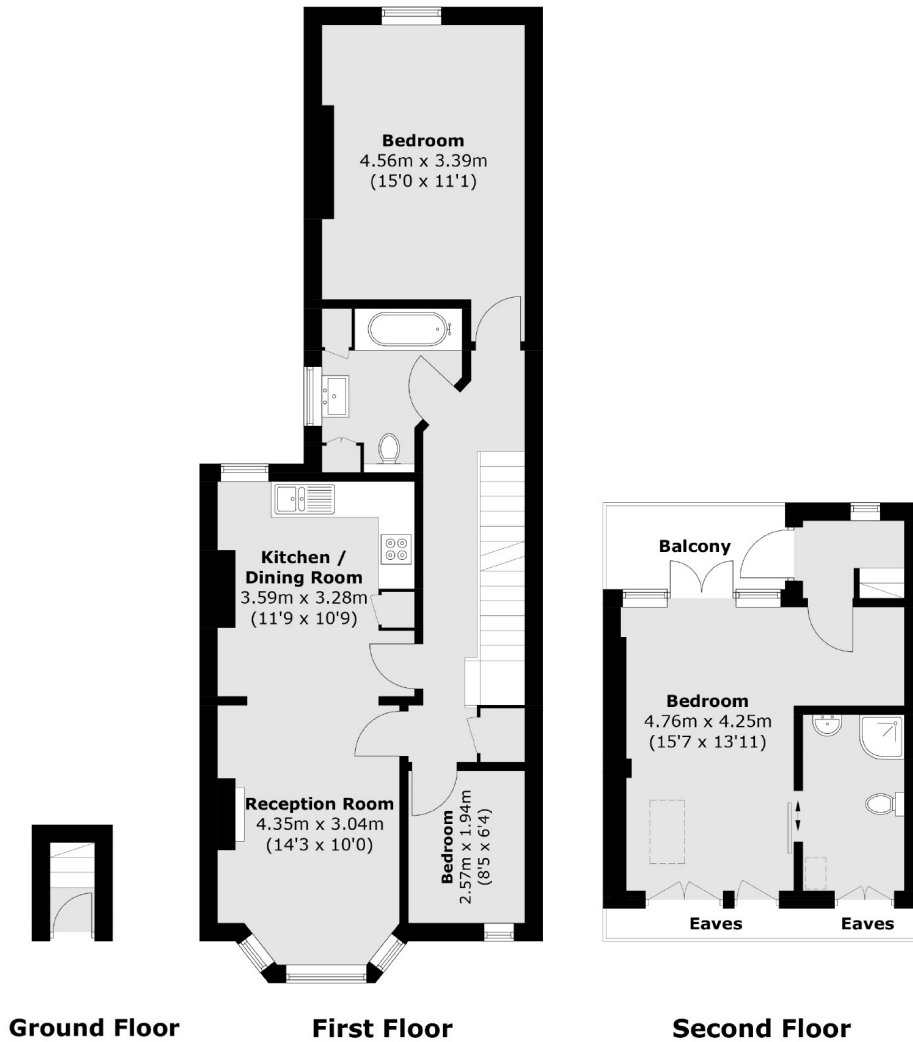

Total area (approx.): 92.4 sq. m (994.5 sq. ft)  
(Excluding Eaves)

Balcony area (approx.): 4.2 sq. m (45.2 sq. ft)

Robertson Smith & Kempson Acton Sales  
137 High Street, Acton,  
London, W3 6LY  
020 8896 3996  
[actonsales@robertsonsmithandkempson.co.uk](mailto:actonsales@robertsonsmithandkempson.co.uk)

Energy Rating: D. We aim to make our particulars both accurate and reliable. However they are not guaranteed; nor do they form part of an offer or contract. If you require clarification on any points then please contact us, especially if you're traveling some distance to view. Please note that appliances and heating systems have not been tested and therefore no warranties can be given as to their good working order.