



## Rosemont Road, W3

£657 pw (£2850.00 pcm)

An immaculately presented two double bedroom apartment with off-street parking. Rosemont Road offers a large master bedroom with high ceilings. This property also benefits from original hardwood flooring and a well maintained garden.

Rosemont Road is ideally located within half a mile of West Acton (Central line), Ealing Common (District and Piccadilly lines) and Acton Main Line (Elizabeth line) stations.

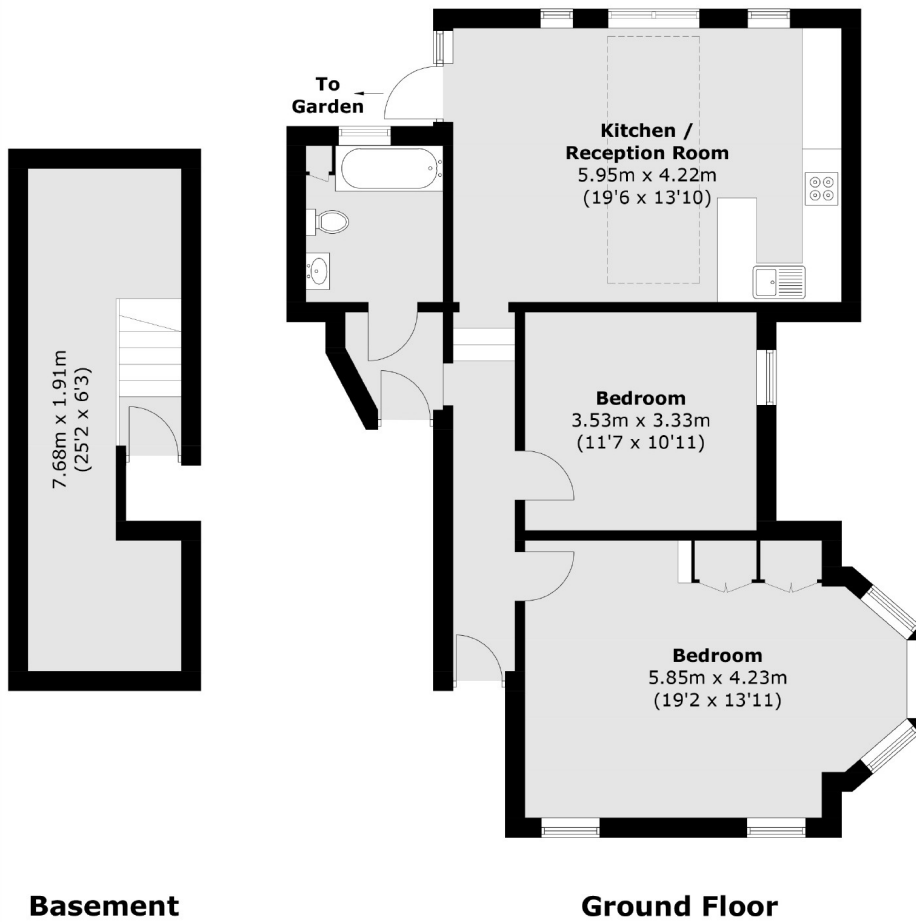

Total area (approx.): 91.5 sq. m (984.9 sq. ft)

Robertson Smith & Kempson Acton Lettings  
137 High Street, Acton, London,  
W3 6LY  
020 8896 3967  
actonlettings@robertsonsmithandkempson.co.uk

Energy Rating: D. We aim to make our particulars both accurate and reliable. However they are not guaranteed; nor do they form part of an offer or contract. If you require clarification on any points then please contact us, especially if you're traveling some distance to view. Please note that appliances and heating systems have not been tested and therefore no warranties can be given as to their good working order.