



## Berrymead Gardens, W3

£1,100,000

A four bedroom family home located on the borders of Chiswick. The property has a large west facing garden and roof terrace on the top floor. The ground floor offers further potential to extend on the ground floor (STPP) and there is no onward chain.



Berrymead Gardens is located approximately 200m from the Ofsted outstanding Ark Priory Academy. Acton Town (District and Piccadilly) and South Acton (Overground) stations are both also within half a mile of the property.

- Four Bedrooms • Two Bathrooms • Victorian •
- West Facing Garden • Roof Terrace • No Onward Chain •





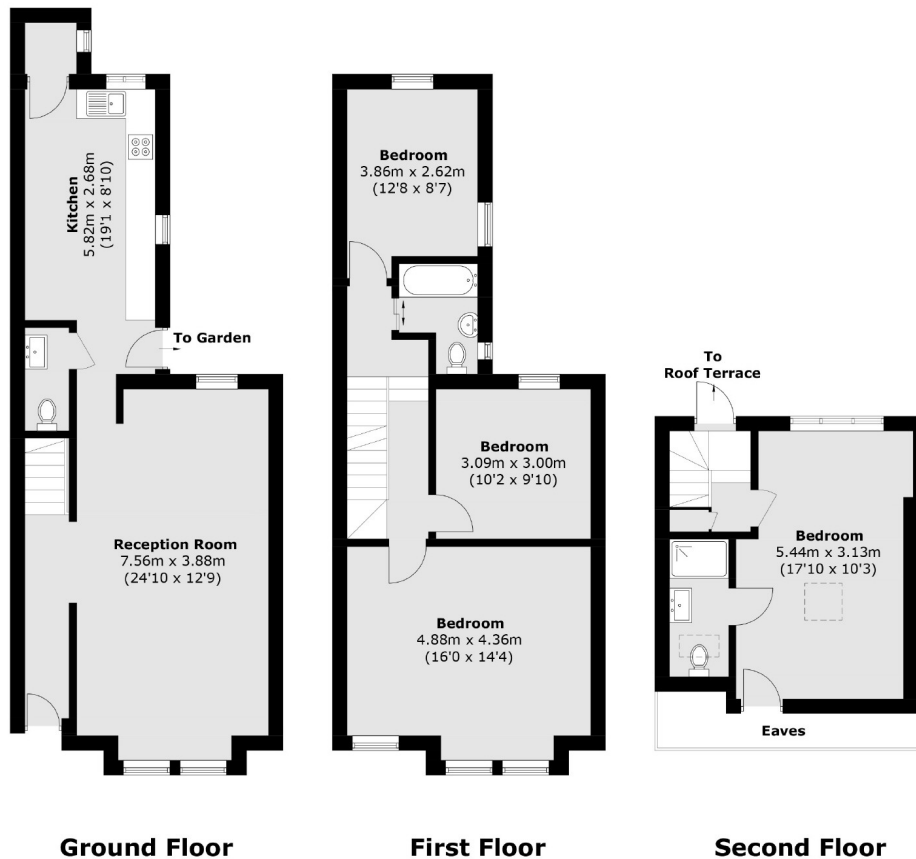

Total area (approx.): 131.5 sq. m (1,415.5 sq. ft)  
(Excluding Eaves)

Robertson Smith & Kempson Acton Sales  
137 High Street, Acton,  
London, W3 6LY  
020 8896 3996  
[actonsales@robertsonsmithandkempson.co.uk](mailto:actonsales@robertsonsmithandkempson.co.uk)

Energy Rating: C. We aim to make our particulars both accurate and reliable. However they are not guaranteed; nor do they form part of an offer or contract. If you require clarification on any points then please contact us, especially if you're traveling some distance to view. Please note that appliances and heating systems have not been tested and therefore no warranties can be given as to their good working order.