



## Park View, W3

£765,000

A mid terrace three bedroom family home moments from the North Acton Playing Fields. This well maintained property offers potential to extend into the loft (STPP), has off-street parking and is offered with no onward chain.

Park View is within half a mile of both North Acton station and the new Elizabeth Line station, Acton Main Line. The A40 also provides easy access into and out of town.

- Three Bedrooms • One Bathroom • Off-Street Parking •
- Potential To Extend (STPP) • No Onward Chain • Close To Stations •

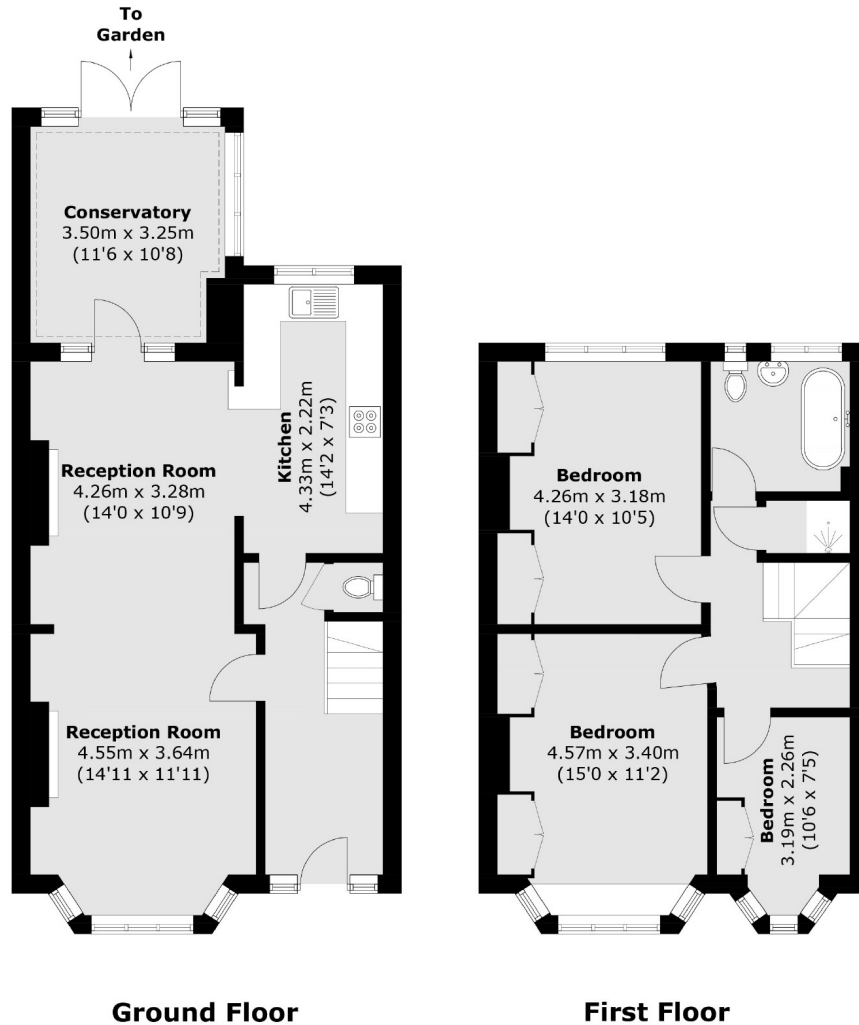

Total area (approx.): 113.8 sq. m (1,224.9 sq. ft)

Robertson Smith & Kempson Acton Sales  
137 High Street, Acton,  
London, W3 6LY  
020 8896 3996  
[actonsales@robertsonsmithandkempson.co.uk](mailto:actonsales@robertsonsmithandkempson.co.uk)

Energy Rating: D. We aim to make our particulars both accurate and reliable. However they are not guaranteed; nor do they form part of an offer or contract. If you require clarification on any points then please contact us, especially if you're traveling some distance to view. Please note that appliances and heating systems have not been tested and therefore no warranties can be given as to their good working order.