



Grove Road, W3

£650,000

An end of terrace three bedroom family home situated between Churchfield Road and Acton High Street. This pretty period property is in need of refurbishment throughout and offers potential to extend on the ground floor and into the loft subject to all the usual consents.

Grove Road is on the borders of Poets Corner and within 500 metres of Acton Central station and the shops and amenities of Churchfield Road.

- Three Bedrooms • End Of Terrace • No Onward Chain •
- Potential To Extend (STPP) • Poets Corner Borders • West Facing Garden •

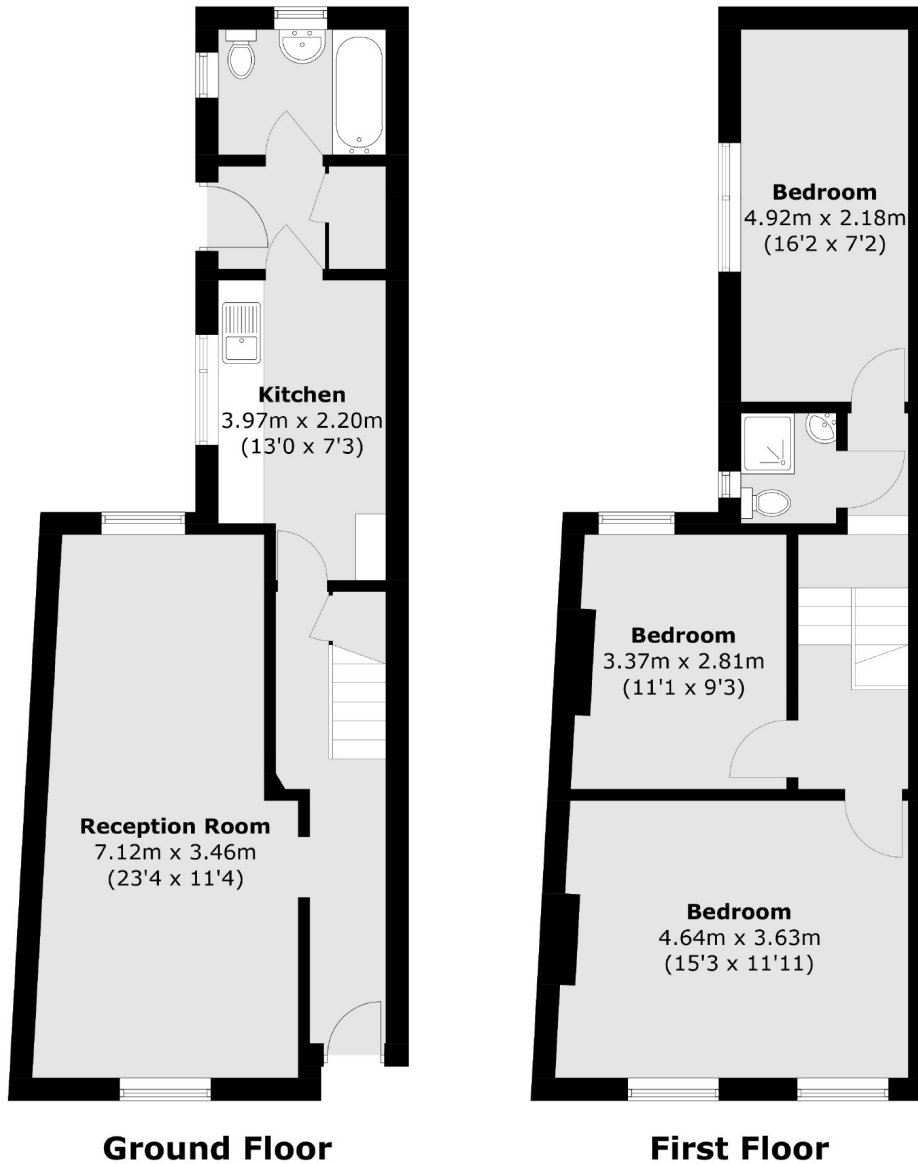

Total area (approx.): 92.7 sq. m (997.8 sq. ft)

Robertson Smith & Kempson Acton Sales
137 High Street, Acton,
London, W3 6LY
020 8896 3996
actonsales@robertsonsmithandkempson.co.uk

Energy Rating: E. We aim to make our particulars both accurate and reliable. However they are not guaranteed; nor do they form part of an offer or contract. If you require clarification on any points then please contact us, especially if you're traveling some distance to view. Please note that appliances and heating systems have not been tested and therefore no warranties can be given as to their good working order.