



## Rosemont Road, W3

£435,000

A purpose built ground floor two bedroom apartment with private garden. The property, which is in excellent condition, is only half a mile from the new Elizabeth line station Acton Main Line and is offered with no onward chain.

Rosemont Road is ideally located within half a mile of West Acton (Central line), Ealing Common (District and Piccadilly lines) and Acton Main Line (Elizabeth line) stations.

## Ground Floor

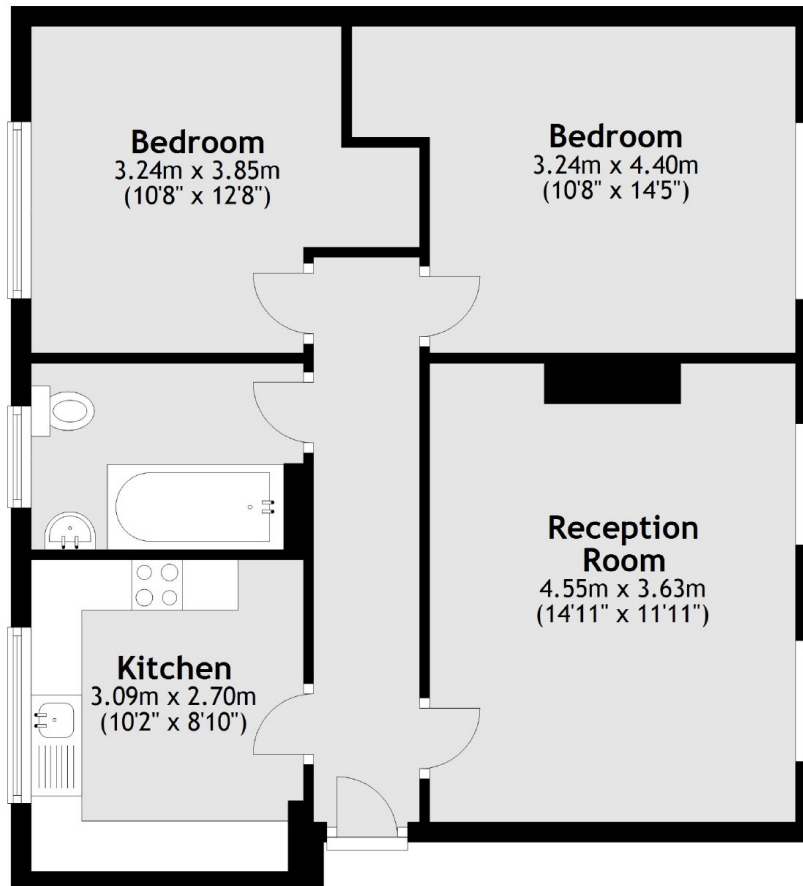

Total area: approx. 61.1 sq. metres (658.0 sq. feet)

Robertson Smith & Kempson Acton Sales  
137 High Street, Acton,  
London, W3 6LY  
020 8896 3996  
[actonsales@robertsonsmithandkempson.co.uk](mailto:actonsales@robertsonsmithandkempson.co.uk)

Energy Rating: C. We aim to make our particulars both accurate and reliable. However they are not guaranteed; nor do they form part of an offer or contract. If you require clarification on any points then please contact us, especially if you're traveling some distance to view. Please note that appliances and heating systems have not been tested and therefore no warranties can be given as to their good working order.