



9 Skylark Close, Basingstoke – RG22 5UR

£675,000 Freehold

5 BEDROOM • STUNNING VIEWS • EXTENDED • ENSUITE TO PRINCIPLE BEDROOM • ENSUITE TO GUEST BEDROOM •
OFF ROAD DRIVEWAY PARKING • SOUTHERLY FACING GARDEN • WALKING DISTANCE TO GREEN SPACE



01256 321777



www.thepropertyexplorer.co.uk

the property
explorer

This extended Bryant-built Milford is a substantial family home, offering versatility across three thoughtfully arranged floors. Owned by the same family since new in 2002, it has been carefully maintained and enhanced, most notably with a ground floor extension completed around eleven years ago. The result is a superb open-plan living area, seamlessly connecting to a southerly facing rear garden. A separate utility room adds further practicality, while outside the property benefits from a private driveway and garage with an electric door. The accommodation is generous and well balanced, featuring five bedrooms in total. Both the principal suite and guest suite enjoy en-suite facilities and an exceptional sense of space, with one commanding the entire top floor and the other positioned on the first floor.

Council Tax band: F

Tenure: Freehold



- › 5 BEDROOM
- › STUNNING VIEWS
- › EXTENDED
- › ENSUITE TO PRINCIPLE BEDROOM
- › ENSUITE TO GUEST BEDROOM
- › OFF ROAD DRIVEWAY PARKING
- › SOUTHERLY FACING GARDEN
- › WALKING DISTANCE TO GREEN SPACE





Approx Gross Internal Area
198 sq m / 2133 sq ft



Ground Floor
Approx 95 sq m / 1018 sq ft

Denotes head height below 1.5m

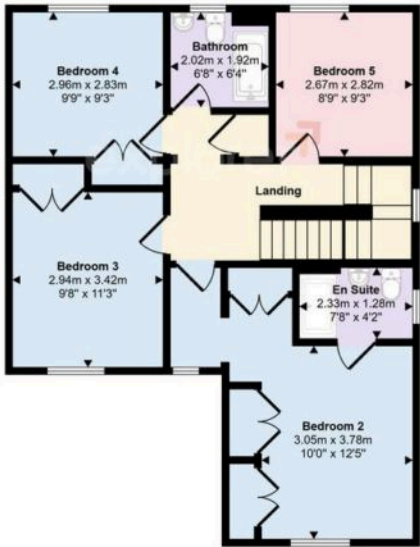

First Floor
Approx 67 sq m / 726 sq ft



Second Floor
Approx 36 sq m / 389 sq ft

This floorplan is only for illustrative purposes and is not to scale. Measurements of rooms, doors, windows, and any items are approximate and no responsibility is taken for any error, omission or mis-statement. Icons of items such as bathroom suites are representations only and may not look like the real items. Made with Made Snappy 360.

You can include any text here. The text can be modified upon generating your brochure.