



Whitgift Close, Beggarwood – RG22 4QJ

£225,000 Leasehold

2 BEDROOMS • ALLOCATED PARKING • LONG LEASE • GAS CENTRAL HEATING • STUNNING VIEWS •
CLOSE TO TRANSPORT LINKS

01256 321777

www.thepropertyexplorer.co.uk

the property
explorer

EXPLORER – This impressive 2 bedroom apartment offers a bright, spacious living environment with far-reaching views across the town and countryside. Positioned on one of the upper floors, it enjoys windows on three sides, flooding the space with natural light. Viewings recommended.

Council Tax band: C

Tenure: Leasehold



- 2 BEDROOMS
- ALLOCATED PARKING
- LONG LEASE
- GAS CENTRAL HEATING
- STUNNING VIEWS
- CLOSE TO TRANSPORT LINKS





Whitgift Close, Beggarwood, Basingstoke, RG22

Approximate Area = 678 sq ft / 63 sq m

For identification only - Not to scale

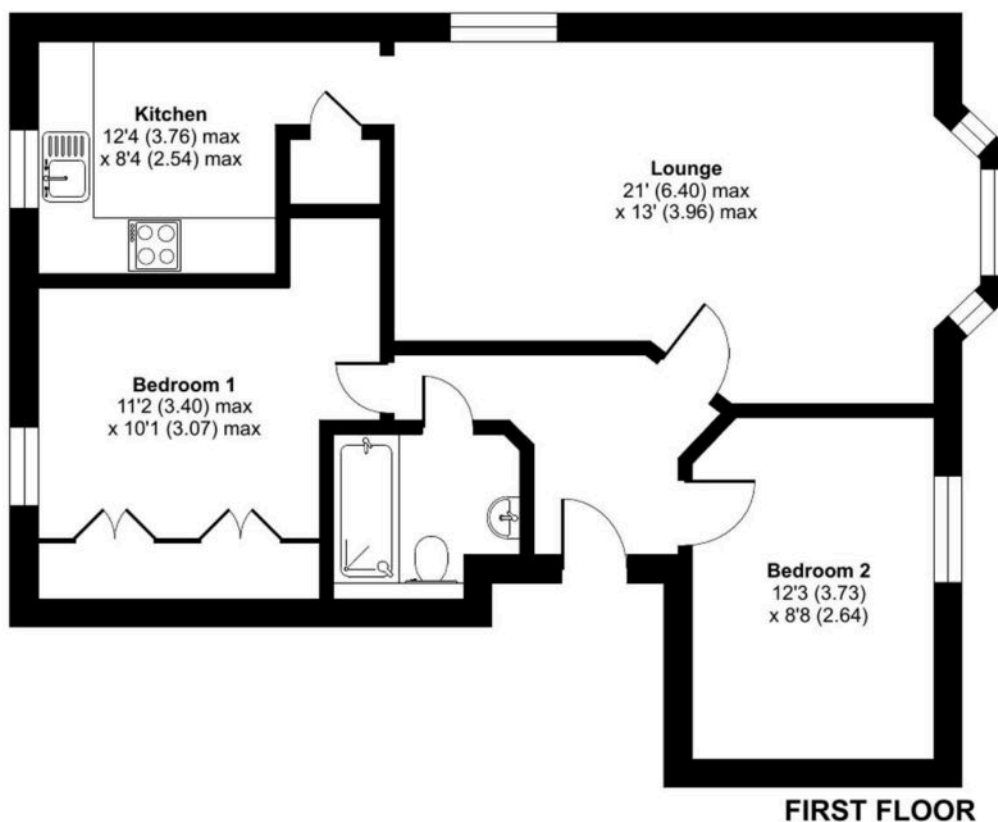

Floor plan produced in accordance with RICS Property Measurement 2nd Edition, Incorporating International Property Measurement Standards (IPMS2 Residential). © nichecom 2025. Produced for Property Explorer. REF: 1310946

Money Laundering Regulations: - Intending purchasers will be asked to produce identification documentation at a later stage and we would ask for your co-operation in order that there will be no delay in agreeing the sale. NB. The information provided about this property does not constitute or form part of an offer or contract, nor may it be regarded as representations. All interested parties must verify accuracy and your solicitor must verify fixtures & fittings and, where the property has been extended/converted, planning/building regulation consents. All dimensions are approximate and quoted for guidance only as are floor plans which are not to scale and their accuracy cannot be confirmed. Reference to appliances and/or services does not imply that they are necessarily in working order or fit for the purpose.