



Wessex Grange Reading Road, Sherfield-On-Loddon - RG27 0ER

£190,000 Leasehold

101 year lease • £1400 p/a service charge • £300 p/a ground rent • boiler annually serviced • 1 allocated parking space

01256 321777

www.thepropertyexplorer.co.uk

the property
explorer

Luxurious One bed flat with opulent design and practical living space. Well-appointed bedroom, spa-like bathroom. Tranquil yet convenient location with excellent transport links. Own this gem of elegance and functionality now.

Council Tax band: C

Tenure: Leasehold

EPC Energy Efficiency Rating: C

EPC Environmental Impact Rating: B



- 101 year lease
- £1400 p/a service charge
- £300 p/a ground rent
- boiler annually serviced
- 1 allocated parking space





GROUND FLOOR
517 sq.ft. (48.0 sq.m.) approx.

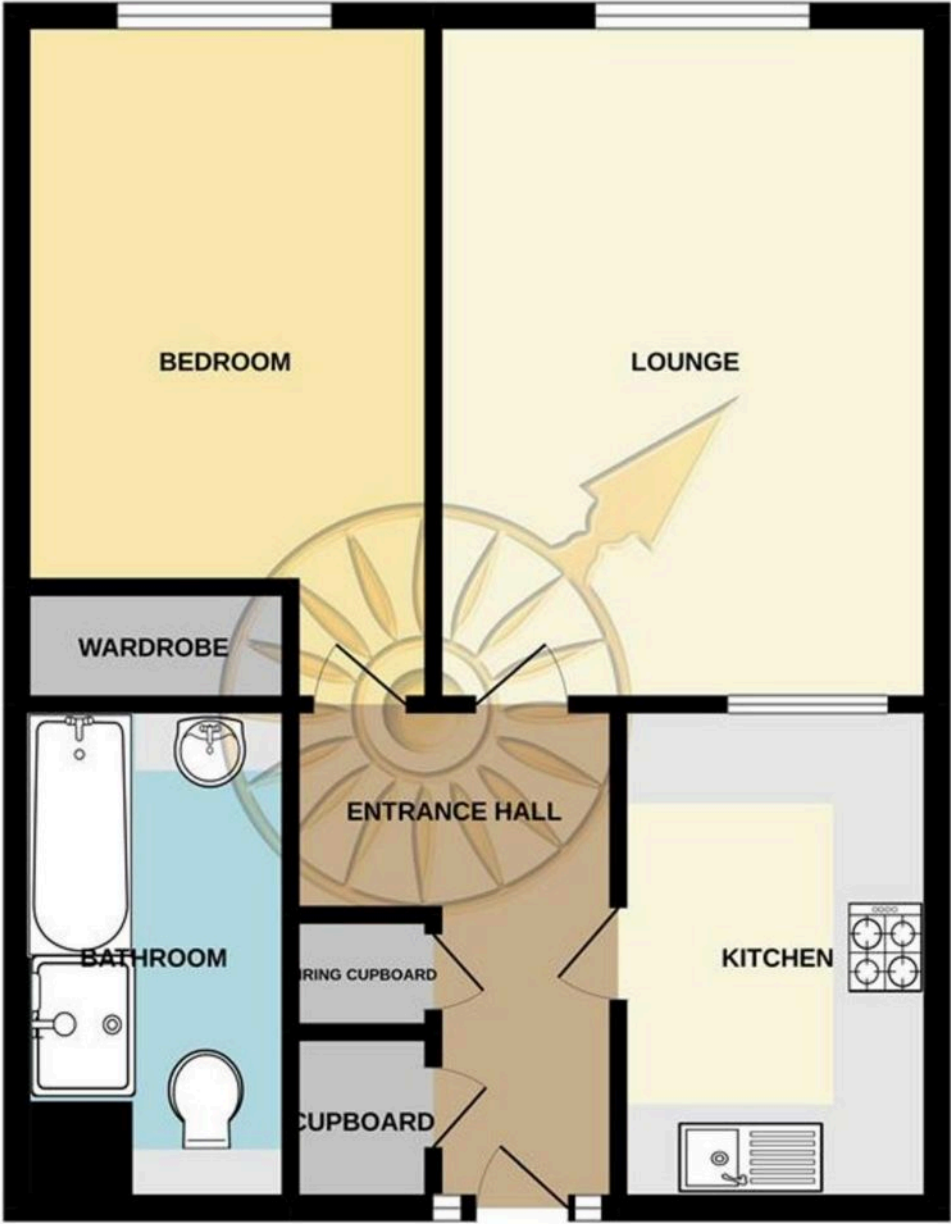

TOTAL FLOOR AREA : 517 sq.ft. (48.0 sq.m.) approx.

Whilst every attempt has been made to ensure the accuracy of the floorplan contained here, measurements of doors, windows, rooms and any other items are approximate and no responsibility is taken for any error, omission or mis-statement. This plan is for illustrative purposes only and should be used as such by any prospective purchaser. The services, systems and appliances shown have not been tested and no guarantee as to their operability or efficiency can be given.

Made with Metropix ©2022

You can include any text here. The text can be modified upon generating your brochure.