



THE PROPERTY  
EXPLORER



95 Beecham Berry, Basingstoke, RG22 4QN

Offers In Excess Of £139,950 Leasehold



# Beecham Berry, Basingstoke, RG22

Approximate Area = 348 sq ft / 32.3 sq m  
For identification only - Not to scale

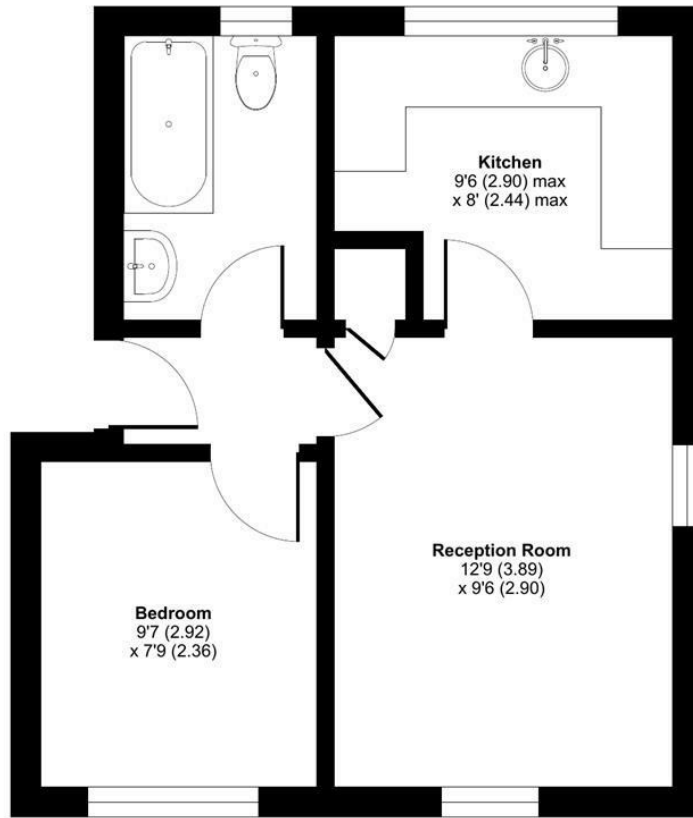

GROUND FLOOR



Floor plan produced in accordance with RICS Property Measurement Standards incorporating International Property Measurement Standards (IPMS2 Residential). © nctecom 2022. Produced for Property Explorer. REF: 913644



These particulars, whilst believed to be accurate are set out as a general outline only for guidance and do not constitute any part of an offer or contract. Intending purchasers should not rely on them as statements of representation of fact, but must satisfy themselves by inspection or otherwise as to their accuracy. No person in this firm's employment has the authority to make or give any representation or warranty in respect of the property.

Arena Business Centre, Suite GF11 The Square, Basing View, Basingstoke, Hampshire, RG21 4EB  
Tel: 01256 321777 Email: [hello@thepropertyexplorer.co.uk](mailto:hello@thepropertyexplorer.co.uk) <https://www.thepropertyexplorer.co.uk>