



THE PROPERTY EXPLORER



Newman Court Barber Road

, Basingstoke, RG22 4BW

Asking Price £161,250
Leasehold



FOR THE OVER 55

Delighted to present to the market this two-bedroom 1st floor apartment which is available on a 75% share, at £161,250.



The property is available on a 75% purchase share at £161,250 the full market value being £215,000 with the remaining 25% owned by the housing association Saxon Weald. The apartment is well appointed throughout with a spacious entrance hall with storage, principal bedroom with Jack & Jill ensuite, double guest bedroom, lounge/dining room, and kitchen. There are a range of in-house facilities, including a canteen, hair salon, activity room, residents lounge and a guest suite. Further benefits include communal gardens, ample parking for residents and guests, access to regular bus routes and different care packages available for varying needs.

Interested buyers will be required to have an assessment with the Scheme Manager to ensure they are suitable for Extra Care and that their needs can be met by the scheme.

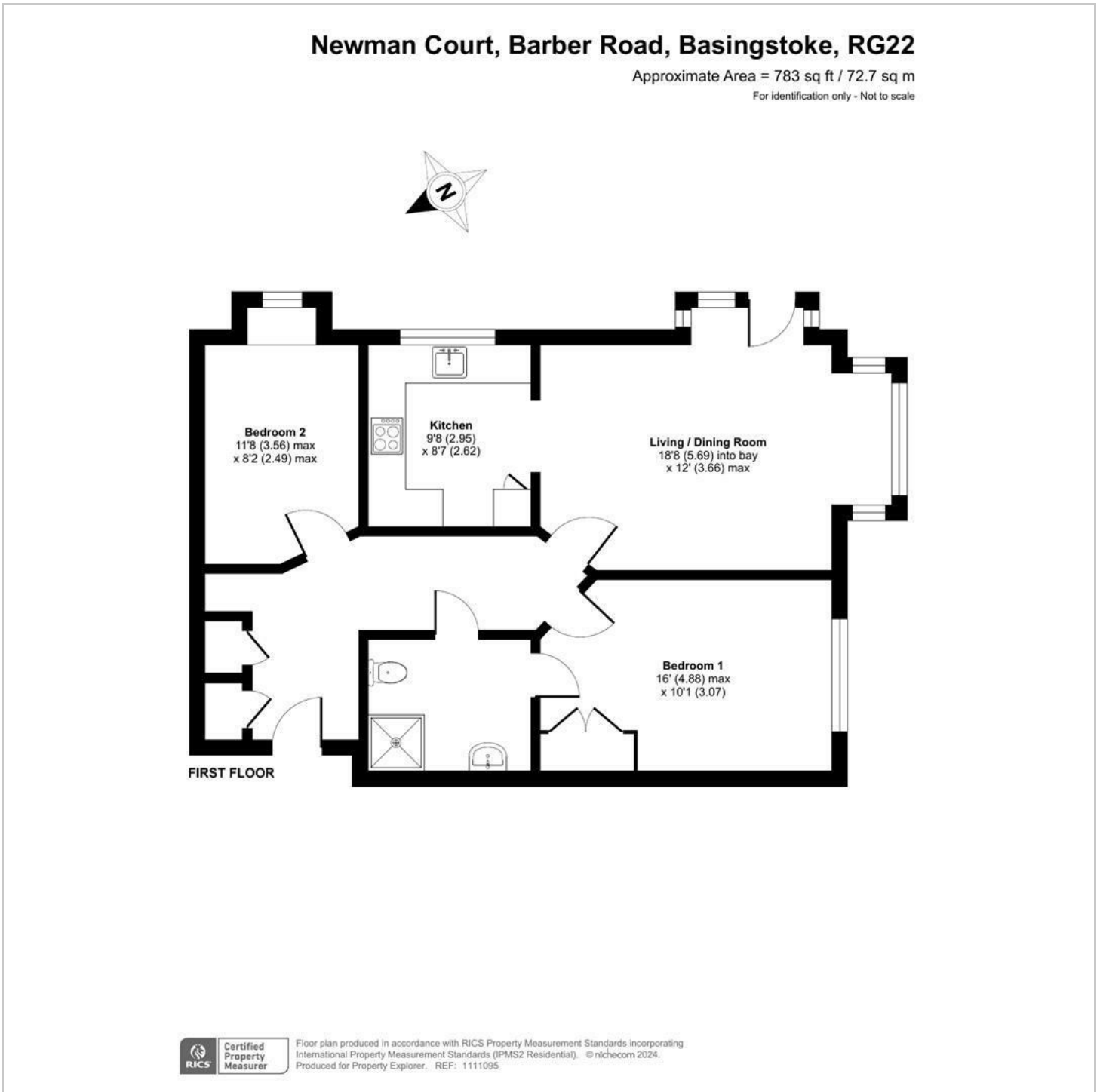

These particulars, whilst believed to be accurate are set out as a general outline only for guidance and do not constitute any part of an offer or contract. Intending purchasers should not rely on them as statements of representation of fact, but must satisfy themselves by inspection or otherwise as to their accuracy. No person in this firm's employment has the authority to make or give any representation or warranty in respect of the property.

www.thepropertyexplorer.co.uk

T 01256 321777 E hello@thepropertyexplorer.co.uk Arena Business Centre, Suite GF11 The Square, Basing View, Basingstoke, Hampshire, RG21 4EB