



14 Pack Lane, Oakley, Basingstoke, Hampshire, RG23 7BE

£850,000 Freehold



THE PROPERTY
EXPLORER



14 Pack Lane, Oakley, Basingstoke, Hampshire, RG23 7BE

£850,000

AGENTS THOUGHTS... Exceptional 4 bedroom detached property perfectly situated on a substantial plot boasting off road driveway parking for multiple vehicles and bespoke purpose built outbuildings to the rear. Viewings highly recommended by the vendors sole agents.

- FOUR BEDROOMS
- THREE BATHROOMS
- REPLACED BOILER 2022
- APPROX. 50" OUTBUILDING
- OFF ROAD PARKING FOR MULTIPLE CARS
- GENEROUS PLOT
- VILLAGE LOCATION
- CONSERVATORY
- TAX BAND - F



Pack Lane, Oakley, Basingstoke, RG23

APPROX. GROSS INTERNAL FLOOR AREA 2085 SQ FT 193.7 SQ METRES (EXCLUDES OUTBUILDING / GARAGE)

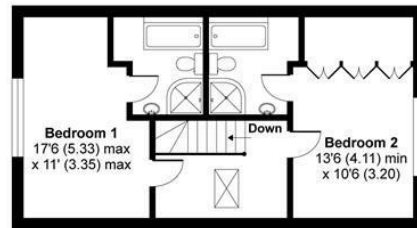

FIRST FLOOR

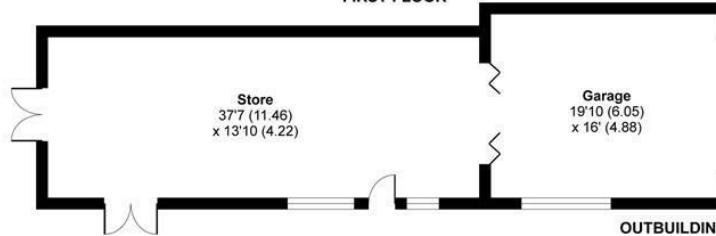

OUTBUILDING



GROUND FLOOR

Whilst every attempt has been made to ensure the accuracy of the floor plan contained here, measurements of doors, windows and rooms are approximate and no responsibility is taken for any error, omission or misstatement. These plans are for representation purposes only as defined by RICS Code of Measuring Practice and should be used as such by any prospective purchaser. Specifically no guarantee is given on the total square footage of the property if quoted on this plan. Any figure given is for initial guidance only and should not be relied on as a basis of valuation.

Copyright nichecom.co.uk 2018 Produced for Property Explorer REF : 369870

These particulars, whilst believed to be accurate are set out as a general outline only for guidance and do not constitute any part of an offer or contract. Intending purchasers should not rely on them as statements of representation of fact, but must satisfy themselves by inspection or otherwise as to their accuracy. No person in this firm's employment has the authority to make or give any representation or warranty in respect of the property.