

Bitterne

023 8042 2600



5 Shrubland Close, Bitterne, Southampton, Hampshire, SO18 5QQ

Offers Over £300,000 Freehold

Draft Details Awaiting Vendor Approval

Welcome to Shrubland Close! Ideal for first-time buyers, this incredibly spacious three-bedroom house is one not to be missed! Nestled in a popular CUL-DE-SAC LOCATION within Bitterne the property offers easy access to all local amenities. Step inside into the entrance porch, leading you into the lounge with a working gas fire, tasteful decoration and plenty of versatility to incorporate a play area or study space. P-shaped, extended kitchen diner with the option of a RangeMaster oven and allocated room an "American Style" fridge freezer, dishwasher and washing machine. Upstairs continues to impress with three well proportioned bedrooms, and double fitted storage to the master bedroom. In our opinion, the garden is the biggest attribute to this stunning home.

fieldpalmer.com

Find us on social media



5 Shrubland Close, Bitterne, Southampton, Hampshire, SO18 5QQ

Offers Over £300,000 Freehold

Welcome to Shrubland Close! Ideal for first-time buyers, this incredibly spacious three-bedroom house is one not to be missed! Nestled in a popular CUL-DE-SAC LOCATION within Bitterne the property offers easy access to all local amenities. Step inside into the entrance porch, leading you into the lounge with a working gas fire, tasteful decoration and plenty of versatility to incorporate a play area or study space. P-shaped, extended kitchen diner with the option of a RangeMaster oven and allocated room an "American Style" fridge freezer, dishwasher and washing machine. Upstairs continues to impress with three well proportioned bedrooms, and double fitted storage to the master bedroom. ... The bathroom a stylish white suite and includes a heated towel rail. In our opinion, the garden is the biggest attribute to this stunning home. Well landscaped and sized from our experience of the road we consider the garden to be one of the largest plots on the road Further benefits include a gas combination boiler, full UPVC double-glazing and a garage! The amount of overall space this property offers makes this the ideal family home. Call us NOW to book your viewing!

Approach

Pathway to front door.

Lounge

16' 3" (4.95m) x 15' 4" (4.67m)::
Smooth ceiling, double glazed window to front, fireplace with surround.

Study Area

12' (3.66m) x 7' 10" (2.39m)::
Smooth ceiling, opening to:

Kitchen Diner

22' 7" (6.88m) max x 15' 3" (4.65m) max reducing to 7::
Smooth ceiling, double glazed window to rear, double glazed sliding doors leading in to rear garden, wall base and drawer units with work surface over, sink and drainer inset, space for appliances.

Landing

Smooth ceiling, storage cupboard, doors to:

Master Bedroom

13' 11" (4.24m) x 9' 4" (2.84m)::
Smooth ceiling, double glazed window to front, built in wardrobes, radiator.

Bedroom Two

11' 8" (3.56m) x 9' 4" (2.84m)::
Smooth ceiling, double glazed window to rear, radiator.

Bedroom Three

10' 9" (3.28m) max x 5' 8" (1.73m)::
Smooth ceiling, double glazed window to front, built in storage cupboard, radiator.

Bathroom

Smooth ceiling, double glazed obscured window to rear, panel enclosed bath with shower over, wash hand basin, WC, ladder towel rail, tiled walls and floor.

Garden

Fence enclosed garden. mainly laid to lawn with patio seating area, shed.

Garage

In block, up and over door.

Services

Mains gas, water, electricity, and drainage are connected. For mobile and broadband connectivity, please refer to Ofcom.org.uk. Please note that none of the services or appliances have been tested by Field Palmer.

Council Tax Band

Band B

Sellers Position

Buying On

Offer Check Procedure

If you are considering making an offer for this property and require a mortgage, our clients will require confirmation of your status. We have therefore adopted an Offer Check Procedure which involves our Financial Advisor verifying your position.

GROUND FLOOR

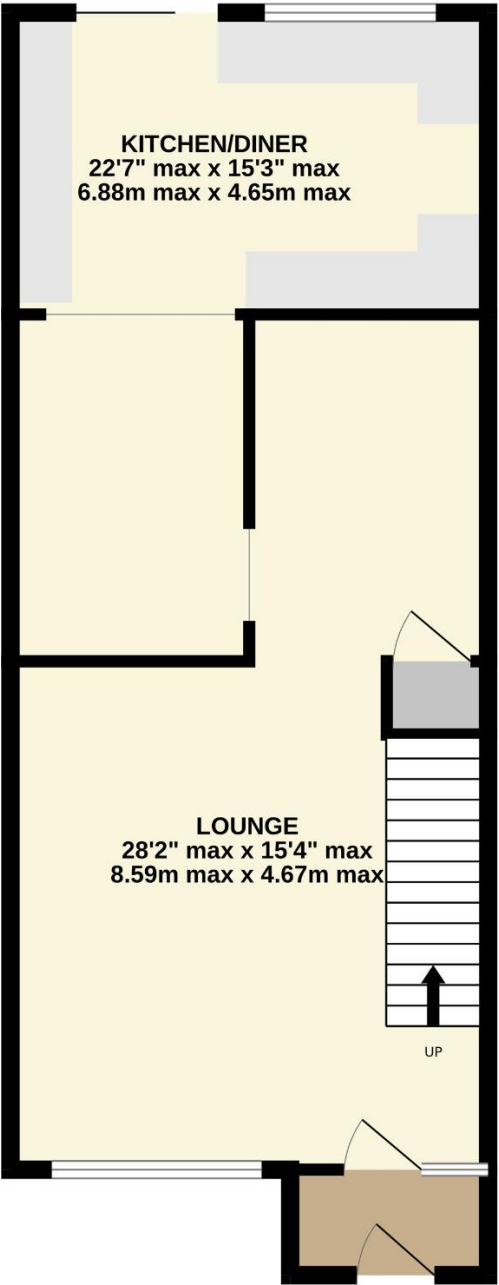

1ST FLOOR

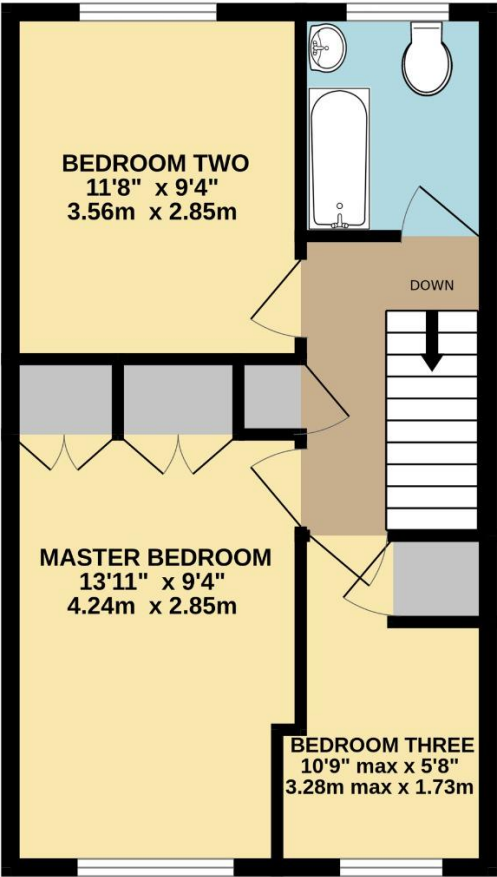

Whilst every attempt has been made to ensure the accuracy of the floorplan contained here, measurements of doors, windows, rooms and any other items are approximate and no responsibility is taken for any error, omission or mis-statement. This plan is for illustrative purposes only and should be used as such by any prospective purchaser. The services, systems and appliances shown have not been tested and no guarantee as to their operability or efficiency can be given.
Made with Metropix ©2026

Bitterne 249 Peartree Avenue Bitterne SO19 7RD 023 8042 2600	Shirley 391 Shirley Road Shirley SO15 3JD 023 8078 0787	Woolston 24 Portsmouth Road Woolston SO19 9AB 023 8039 3255	Auction Department 62 High Street West End SO30 3DT 023 8047 4274	Lettings & Block Management 2-4 New Road Southampton SO14 0AA 023 8071 0402	Do you need an Energy Performance Certificate? Field Palmer are able to offer EPC services across Hampshire and the south of England. We can offer mortgage advice Want to get the best mortgage, but don't know which one is right for you? We can advise you on discounted, fixed rate, tracker, off-set, buy to let, non status, re-mortgage and more.	
--	---	---	---	---	--	--