



## Wraysbury

**£1,550 PCM**

A fabulous two bedroom first floor maisonette with a charming private garden and excellent outside storage. The property comprises: entrance hall, lounge, fitted kitchen/breakfast room, bathroom, two bedrooms. The property benefits from two off street parking spaces. Unfurnished. Available July 2024. Energy rating: D



**B.S. Bennett Estate Agents**

2 Staines Road, Wraysbury, Staines, Middlesex, TW19 5BS

t: 01784 483839 e: post@bsbennett.co.uk

**bsbennett.co.uk**

**B. S. BENNETT**



**Location:**

Wraysbury is a thriving village with all the amenities that one could ask for including charming country pubs, local post office, pharmacy, hardware shop, newsagent, The Kitchen Cafe and Co-op. Wraysbury offers a unique opportunity to those seeking to combine traditional values of a village environment together with the accessibility and convenience of modern day living. Within a short drive you will find Windsor itself, steeped in history with its castle and royal connections. Staines town centre provides an excellent array of shopping facilities, restaurants and cinema. Ideal for commuters with Wraysbury and Sunnymeads stations providing direct links into Windsor & London Waterloo, together with easy access of Motorways M25, M4, M3 and London Heathrow Airport.

**Deposit:**

5 weeks rent which is £1785.00 for this rental. The deposit is used to cover any potential damages. The deposit will be protected by one of the approved schemes.

**Local Authority:**

Royal Borough of Windsor & Maidenhead, Town Hall, St.Ives Road, Maidenhead, Berkshire, SL6 1RF.

Telephone 01628 798888

Council Tax Band: D

Payable 2024/25: £1697.93

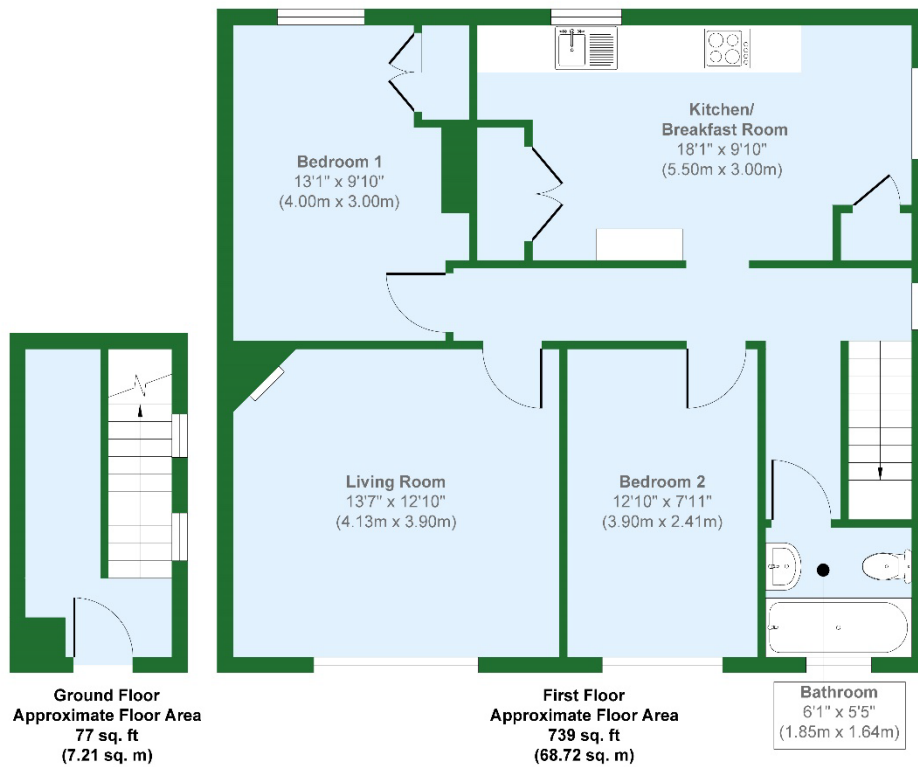

**Approx. Gross Internal Floor Area 816 sq. ft / 75.93 sq. m**

Illustration for identification purposes only. measurements are approximate, not to scale.

Produced by Elements Property