



## Old Dairy Court, Mildenhall, Suffolk, IP28 7FG

Rent - £1,280 PCM

Deposit - £1,476

This modern mid terrace house is very close to Mildenhall base & is presented to a good standard with modern bathrooms & kitchen with appliances built in. There is an lounge/diner and 3 bedrooms, one of which has closets. Enclosed garden. Carport & parking to the rear.

- MID TERRACED HOUSE
- 3 GOOD SIZED BEDROOMS
- SPACIOUS LOUNGE
- EN-SUITE, FAMILY BATHROOM & CLOAKROOM
- CARPORT & PARKING
- CLOSE TO RAF BASES
- GAS HEATING & ENERGY RATING - C
- APPROXIMATE SIZE - 817 SQFT
- COUNCIL TAX BAND - C
- AVAILABLE SOON



Council Tax Band: C - EPC Rating: C 79



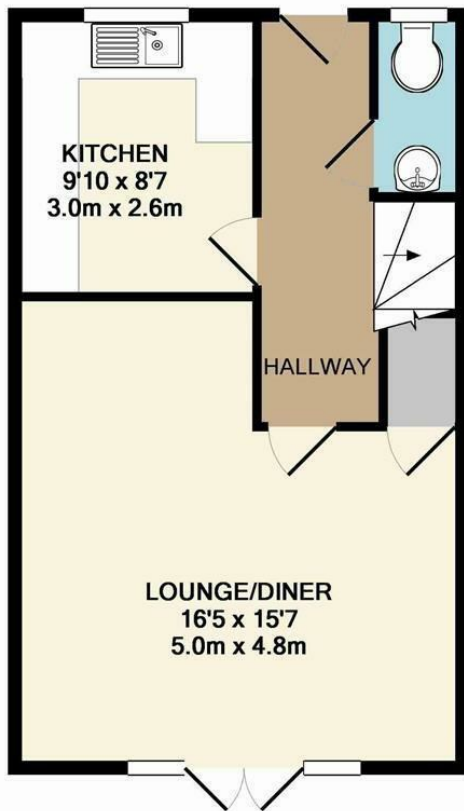

GROUND FLOOR  
APPROX. FLOOR  
AREA 409 SQ.FT.  
(38.0 SQ.M.)

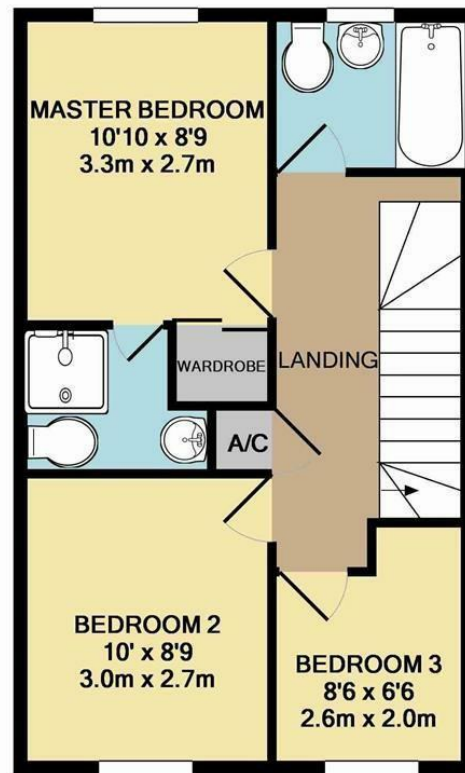

1ST FLOOR  
APPROX. FLOOR  
AREA 409 SQ.FT.  
(38.0 SQ.M.)

**TOTAL APPROX. FLOOR AREA 817 SQ.FT. (75.9 SQ.M.)**

Whilst every attempt has been made to ensure the accuracy of the floor plan contained here, measurements of doors, windows, rooms and any other items are approximate and no responsibility is taken for any error, omission, or mis-statement. This plan is for illustrative purposes only and should be used as such by any prospective purchaser. The services, systems and appliances shown have not been tested and no guarantee as to their operability or efficiency can be given

Made with Metropix ©2013

