



Gorse Close, Brandon, IP27 9DE

Rent - £1,150 PCM

Deposit - £1,326

Beautifully Refurbished One Bedroom Bungalow – Available Now

This charming one-bedroom bungalow has been newly refurbished throughout, offering modern, comfortable living in a quiet and convenient location in Lakenheath.

The property features a brand-new kitchen complete with appliances, a bright and spacious living room, a contemporary shower room, and an upstairs double bedroom. Externally, the home benefits from an enclosed garden and off-road parking.

- BRAND NEW REFURBISHMENT
- OPEN PLAN LIVING AREA
- BRAND NEW BATHROOM
- ENCLOSED REAR GARDEN
- CLOSE TO RAF BASES
- ONE BEDROOM BUNGALOW
- BRAND NEW KITCHEN WITH APPLIANCES
- BUILT IN STORAGE
- OFF ROAD PARKING
- CALL SHIRES TO VIEW



Council Tax Band: A - EPC Rating: E 48

GROUND FLOOR
31.2 sq.m. (336 sq.ft.) approx.



1ST FLOOR
17.5 sq.m. (189 sq.ft.) approx.

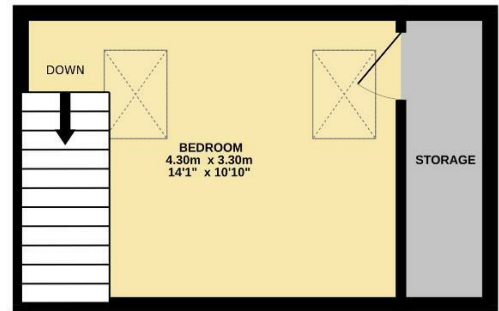

TOTAL FLOOR AREA : 48.8 sq.m. (525 sq.ft.) approx.

Whilst every attempt has been made to ensure the accuracy of the floorplan contained here, measurements of doors, windows, rooms and any other items are approximate and no responsibility is taken for any error, omission or mis-statement. This plan is for illustrative purposes only and should be used as such by any prospective purchaser. The services, systems and appliances shown have not been tested and no guarantee as to their operability or efficiency can be given.
Made with Metropix ©2025

