



Frederick Talbot Close, Soham, Cambridgeshire, CB7 5EY

Rent - £1,200 PCM

Deposit - £1,384

Frederick Talbot Close in Soham, this three-bedroom house offers a perfect blend of comfort and practicality. Entering, you are greeted by a spacious separate lounge, ideal for relaxation or entertaining guests. The heart of the home is undoubtedly the well-appointed kitchen/diner, which provides space for family meals and gatherings.

Downstairs, the property boasts a convenient downstairs WC, and, the conservatory invites an abundance of natural light.

- THREE BEDROOMS
- KITCHEN/DINER
- DOWNSTAIRS WC
- OFF ROAD PARKING
- CLOSE TO AMENITIES
- SPACIOUS SEPARATE LOUNGE
- BRIGHT AIRY CONSERVATORY
- IDEAL FAMILY HOME
- GARAGE
- GREAT TRANSPORT LINKS



Council Tax Band: C - EPC Rating: D 65

GROUND FLOOR
48.7 sq.m. (525 sq.ft.) approx.

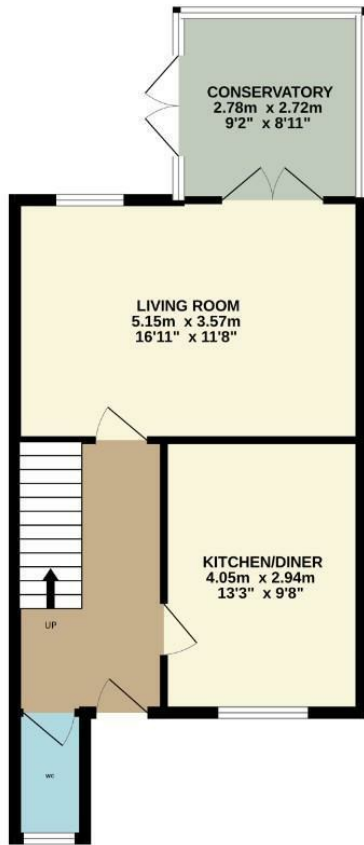

1ST FLOOR
39.2 sq.m. (422 sq.ft.) approx.

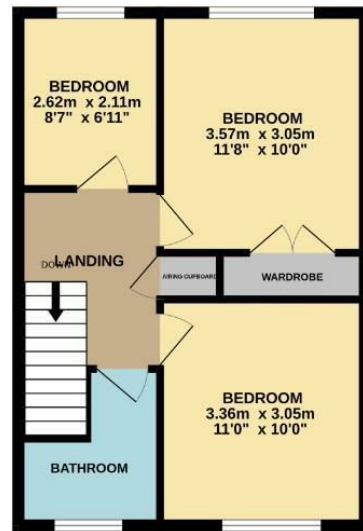

TOTAL FLOOR AREA: 88.0 sq.m. (947 sq.ft.) approx.

Whilst every attempt has been made to ensure the accuracy of the floorplan contained here, measurements of doors, windows, rooms and any other items are approximate and no responsibility is taken for any error, omission or mis-statement. This plan is for illustrative purposes only and should be used as such by any prospective purchaser. The services, systems and appliances shown have not been tested and no guarantee as to their operability or efficiency can be given.
Made with Metropac ©2025.

