



## High Street, Soham, Cambridgeshire, CB7 5HE

Rent - £900 PCM      Deposit - £1,038

A well-presented first-floor apartment ideally located on the High Street in the heart of Soham. Offering a bright open-plan living area with a modern fitted kitchen, two bedrooms, and a family bathroom. Additional benefits include an off-road parking space and easy access to local shops, cafes, and amenities. Conveniently situated near the train station for excellent commuting links. Available now-ideal for professionals or couples seeking town-centre living.

- TWO BEDROOM APARTMENT
- OPEN PLAN KITCHEN/ LIVING/ DINING AREA
- FIRST FLOOR
- COUNCIL TAX
- CALL SHIRES TO VIEW
- OFF PARKING SPACE
- TOWN CENTRE LOCATION
- WALKING DISTANCE TO TRAIN STATION
- AVAILABLE NOW



GROUND FLOOR  
42.0 sq.m. (452 sq.ft.) approx.

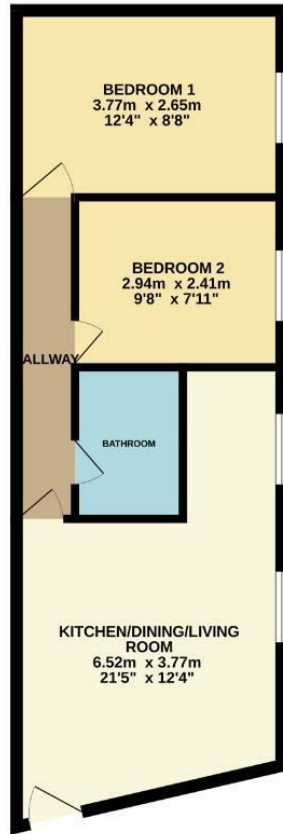

TOTAL FLOOR AREA: 42.0 sq.m. (452 sq.ft.) approx.

Whilst every attempt has been made to ensure the accuracy of the floorplan contained here, measurements of doors, windows, rooms and any other items are approximate and no responsibility is taken for any error, omission or misstatement. This plan is for illustrative purposes only and should be used as such by any prospective purchaser. The services, systems and appliances shown have not been tested and no guarantee as to their operability or efficiency can be given.  
Made with Metropex ©2025

