

# 5 Madison Mews - Asking Price £650,000

Beck Row Bury St. Edmunds IP28 8ZJ

**shires**

Estate & Letting Agents



*"Consistently providing outstanding service to our clients"*



# Asking Price £650,000

## The Property

Nestled in the prestigious Madison Mews, Beck Row, this nearly new luxury house offers an exceptional living experience with four spacious bedrooms and two well-appointed bathrooms, this property is perfect for families seeking both comfort and style.

As you enter, you are greeted by three elegant reception rooms, providing ample space for relaxation and entertaining. The high-quality finish throughout the home is evident, showcasing modern design and attention to detail. The fully fitted kitchen, complete with a central island and a convenient utility room, is a chef's dream, making meal preparation a delight.

The property boasts a double garage with a powered door, offering secure parking for up to four vehicles, including the parking, along with a loft room above that can serve as a versatile space for hobbies or additional storage. The home is situated within a bespoke development of luxury residences, ensuring a sense of exclusivity and community.

Backing onto the tranquil Aspal Lane Nursery, residents can enjoy views and a serene environment. This property is not just a house; it is a place to create lasting memories. With its prime location and exceptional features, this home is a rare find in the market. Do not miss the opportunity to make it your own.

## Features

- PRIVATE CUL DE SAC LOCATION, BACKING ASPAL LANE NURSERY
- AIR SOURCE HEATING THROUGHOUT
- 7 YEAR OLD FAMILY HOME
- DOUBLE GARAGE WITH ROOM ABOVE AND PARKING FOR 4 FURTHER VEHICLES
- LARGE FAMILY SIZED GARDEN
- BIFOLD DOORS FROM LOUNGE AND KITCHEN
- 4 DOUBLE BEDROOMS
- DINING ROOM, STUDY AND DOUBLE ASPECT LOUNGE
- FAMILY BATHROOM, EN-SUITE SHOWER ROOM & GROUND FLOOR CLOAKROOM
- LARGE FITTED KITCHEN WITH ISLAND & UTILITY ROOM







These sales particulars have been produced as a general guide only and we would draw to your attention that we have not carried out a detailed Survey of the property nor have we tested services, appliances or specific fittings. Whilst measurements and statements given within the details are provided in good faith, their accuracy should not be relied upon. If there are any points about which you may be uncertain or would like further clarification, we would suggest that you telephone this office and speak to our staff who will endeavour to assist you.



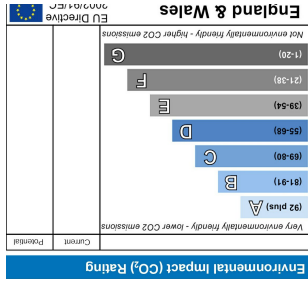
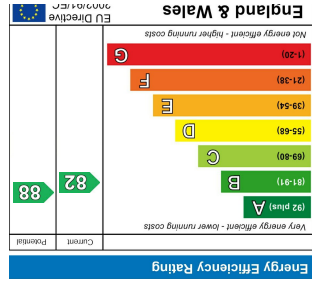

Whilst every attempt has been made to ensure the accuracy of the floorplan contained here, measurements of doors, windows, rooms and any other items are approximate and no responsibility is taken for any error, omission or mis-statement. This plan is for illustrative purposes only and should be used as such by any prospective purchaser. The services, systems and appliances shown have not been tested and no guarantee as to their operability or efficiency can be given.

Made with Metropix ©2025

**TOTAL FLOOR AREA : 281.1 sq.m. (3026 sq.ft.) approx.**

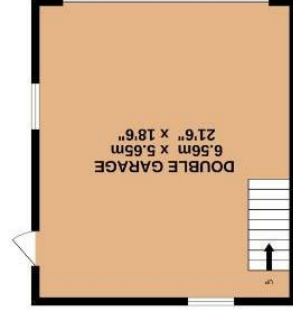

**GROUND FLOOR**  
147.4 sq.m. (1586 sq.ft.) approx.



**1ST FLOOR**  
133.7 sq.m. (1440 sq.ft.) approx.

