



## Queensway, Mildenhall, Suffolk, IP28 7JJ

Rent - £1,150 PCM      Deposit - £1,326

### \*\*TLF SHORT OR LONG TERM RENTAL\*\*

This 1 bedroom end of terrace house is located close to RAF bases & the town centre. The property comprises of a spacious open plan lounge & kitchen, 1 bedroom & a spacious shower room. There is off road parking & a courtyard to the rear of the property. This property is available either furnished or unfurnished, and for either a long or short term tenancy.

- END OF TERRACE HOUSE
- 1 BEDROOM
- AVAILABLE FOR SHORT OR LONG TERM
- SHOWER ROOM
- OFF ROAD PARKING & COURTYARD
- FURNISHED
- GAS HEATING & ENERGY RATING - C
- APPROXIMATE SIZE - 495 SQ FT
- PETS CONSIDERED / COUNCIL TAX BAND - A
- AVAILABLE NOW



Council Tax Band: A - EPC Rating: C 76



GROUND FLOOR  
25.6 sq.m. (276 sq.ft.) approx.



1ST FLOOR  
16.7 sq.m. (180 sq.ft.) approx.

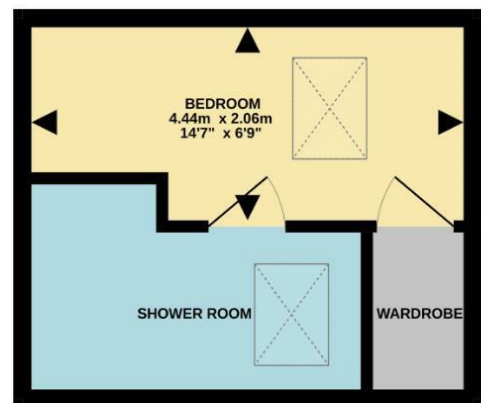

TOTAL FLOOR AREA : 42.3 sq.m. (455 sq.ft.) approx.

Whilst every attempt has been made to ensure the accuracy of the floorplan contained here, measurements of doors, windows, rooms and any other items are approximate and no responsibility is taken for any error, omission or mis-statement. This plan is for illustrative purposes only and should be used as such by any prospective purchaser. The services, systems and appliances shown have not been tested and no guarantee as to their operability or efficiency can be given.  
Made with Metropix ©2025

