



## The Street, Gooderstone, Norfolk, PE33 9BP

**Rent - £1,150 PCM      Deposit - £1,326**

A detached, spacious home in a village location with four double bedrooms, kitchen, utility room and two bathrooms. Outside there is a double garage, ample off road parking and large gardens adjoining Gooderstone Water Gardens.

- DETACHED HOUSE
- 4 GOOD SIZED BEDROOMS
- UTILITY ROOM
- 2 BATHROOMS
- GARDENS, DOUBLE GARAGE & OFF ROAD PARKING
- CONSERVATORY
- OIL HEATING AND ENERGY RATING - D
- APPROXIMATE SIZE - 2781 SQ FT
- PETS CONSIDERED
- CALL NOW TO BOOK YOUR VIEWING!



Council Tax Band: G - EPC Rating: D 57





GROUND FLOOR  
APPROX. FLOOR  
AREA 1708 SQ.FT.  
(158.7 SQ.M.)

TOTAL APPROX. FLOOR AREA 2781 SQ.FT. (258.4 SQ.M.)

Whilst every attempt has been made to ensure the accuracy of the floor plan contained here, measurements of doors, windows, rooms and any other items are approximate and no responsibility is taken for any error, omission, or mis-statement. This plan is for illustrative purposes only and should be used as such by any prospective purchaser. The services, systems and appliances shown have not been tested and no guarantee as to their operability or efficiency can be given.  
Made with Metropix ©2017

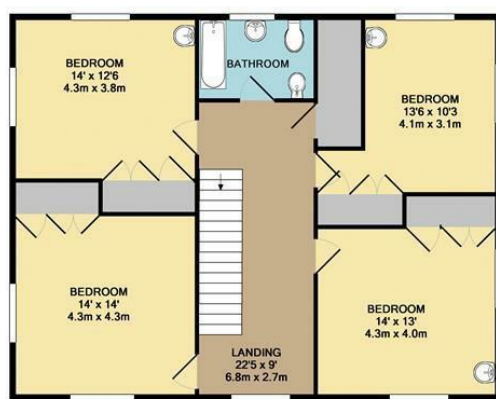

FIRST FLOOR  
APPROX. FLOOR  
AREA 1073 SQ.FT.  
(99.7 SQ.M.)

