



Yew Tree Close, Mildenhall, Suffolk, IP28 7SJ

Rent - £1,150 PCM Deposit - £1,326

This pleasant 2 bedroom house located in Mildenhall features modern accommodation and has been finished to a high standard throughout. Lounge/dining room, 1.5 bathrooms, low maintenance garden and parking.

- MODERN HOUSE
- 2 GOOD SIZED BEDROOMS
- LOUNGE/DINING ROOM
- FAMILY BATHROOM & SEPARATE WC DOWNSTAIRS
- AVAILABLE AT THE BEGINNING OF JUNE
- CLOSE TO RAF MILDENHALL & LAKENHEATH
- GAS HEATING & ENERGY RATING - C
- APPROXIMATE SIZE - 760 SQ FT
- LOW MAINTENANCE GARDEN & PARKING



Council Tax Band: B - EPC Rating: C 77

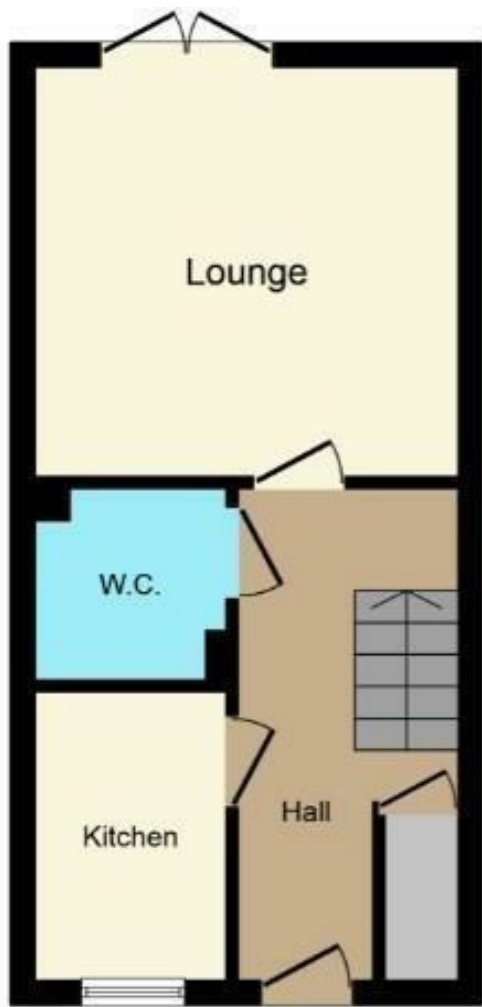

Ground Floor

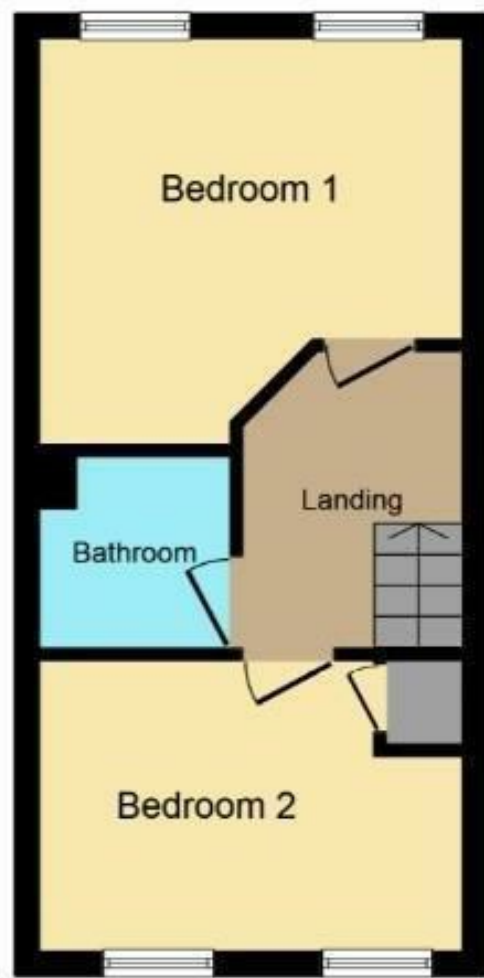

First Floor

This plan is for illustration purposes only and may not be representative of the property. Plan not to scale.

