



## Bell Lane, Bury St. Edmunds, IP28 6AJ

Rent - £800 PCM

Deposit - £923

A 1 bedroom bungalow located in the popular village of Barton Mills. The property, which is an annexe to the main house, was constructed around 3 years ago and therefore has new fittings throughout. The property comes with parking directly outside for 1 vehicle.

- 3 YEAR OLD ANNEXE
- ELECTRIC HEATING
- MODERN SHOWER ROOM
- POPULAR VILLAGE LOCATION
- AVAILABLE IMMEDIATELY
- PARKING DIRECTLY OUTSIDE ON THE DRIVE FOR 1 CAR
- FITTED KITCHEN
- BEDROOM WITH BUILT IN WARDROBES
- CLOSE TO MILDENHALL AND LAKENHEATH AIR BASES
- CALL NOW TO VIEW



Council Tax Band: A - EPC Rating: D 62



GROUND FLOOR  
39.0 sq.m. (419 sq.ft.) approx.

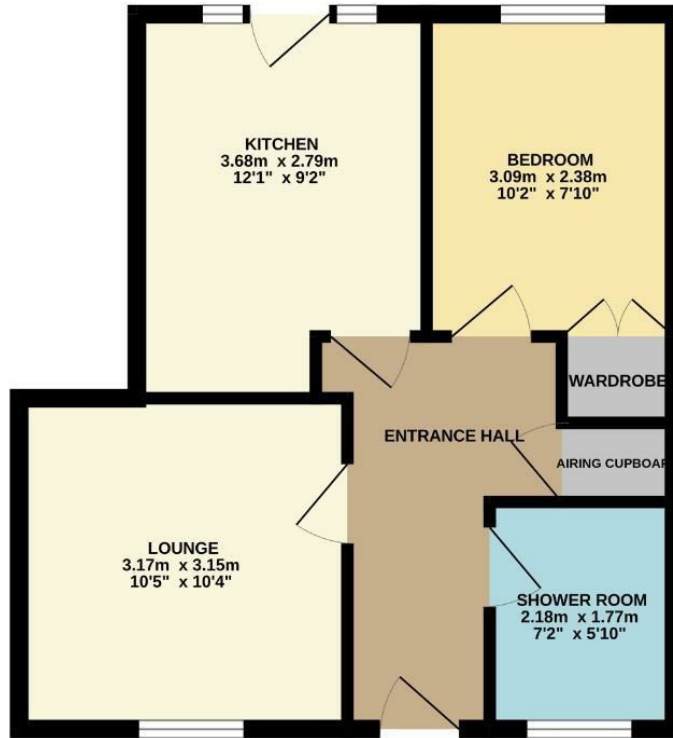

TOTAL FLOOR AREA : 39.0 sq.m. (419 sq.ft.) approx.  
Whilst every attempt has been made to ensure the accuracy of the floorplan contained herein, measurements of doors, windows, rooms and any other items are approximate and no responsibility is taken for any error, omission or mis-statement. This plan is for illustrative purposes only and should be used as such by any prospective purchaser. The services, systems and appliances shown have not been tested and no guarantee as to their operability or efficiency can be given.  
Made with Metropix 02/2024.

