

7 Raven Close - Guide Price £234,995

Mildenhall Suffolk IP28 7LF



"Consistently providing outstanding service to our clients"

Guide Price £234,995

The Property

This two bedroom semi detached bungalow is within walking distance of the towns amenities. The property consists of a spacious lounge, modern kitchen, shower room, enclosed garden, garage and parking.

Features

- SEMI DETACHED BUNGALOW
- WITHIN WALKING DISTANCE TO TOWN CENTRE
- TWO GOOD SIZED BEDROOMS
- GAS HEATING & ENERGY RATING - D
- CHAIN FREE
- APPROXIMATE SIZE - 677 SQ FT
- SHOWER ROOM
- ENCLOSED GARDEN, GARAGE & PARKING





These sales particulars have been produced as a general guide only and we would draw to your attention that we have not carried out a detailed Survey of the property nor have we tested services, appliances or specific fittings. Whilst measurements and statements given within the details are provided in good faith, their accuracy should not be relied upon. If there are any points about which you may be uncertain or would like further clarification, we would suggest that you telephone this office and speak to our staff who will endeavour to assist you.

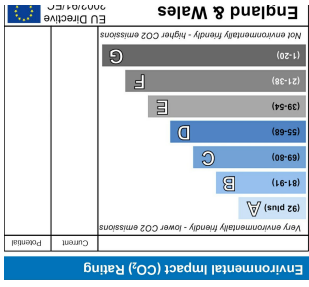
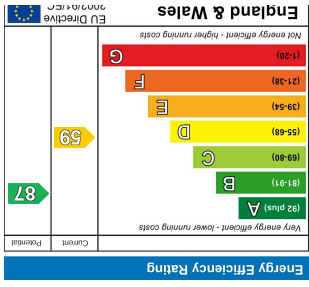

Shires Residential
 4 New Street, Mildenhall, Suffolk, IP28 7EN
 T: 01638 712132
 E: mildenhall@shiresresidential.com
 www.shiresresidential.com

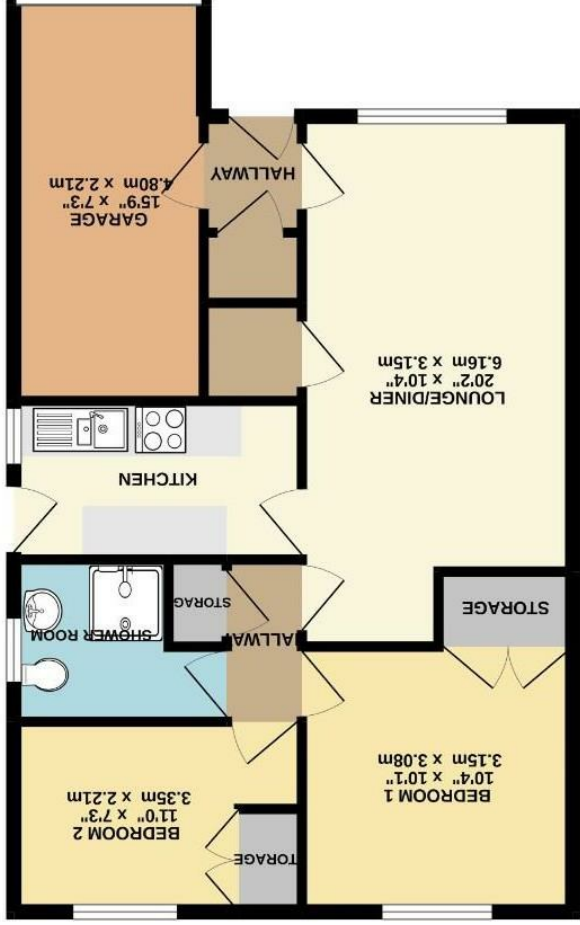

GROUND FLOOR
677 sq. ft. (62.9 sq. m.) approx.

Whilst every attempt has been made to ensure the accuracy of the information contained herein, measurements of areas, volumes, rates and other items are approximately and no responsibility is taken for any errors, omissions, errors and other items are approximately and no responsibility is taken for any errors, omissions or mis-statement. This plan is for illustrative purposes only and should be used as such by any prospective purchaser. The service, expertise and experience can be given as to their operation or efficiency can be given.

Made with Autopix 4/2022

TOTAL FLOOR AREA: 677 sq. ft. (62.9 sq. m.) approx.