



Clover Way, Red Lodge, Suffolk, IP28 8TB
Rent - £1,125 PCM Deposit - £1,298

This good size semi-detached home is located in the often requested village of Red Lodge. The property offers 3 bedrooms, large lounge and kitchen, separate utility room and 2 bathrooms. Enclosed garden, garage & parking.

- SEMI DETACHED HOUSE
- 3 BEDROOMS
- UTILITY ROOM
- FAMILY BATHROOM & SHOWER ROOM
- ENCLOSED GARDEN, GARAGE & PARKING
- LARGE LOUNGE
- ELECTRIC HEATING & ENERGY RATING - E
- APPROXIMATE SIZE - 1119 SQ FT
- PETS CONSIDERED / COUNCIL TAX BAND - B
- AVAILABLE AT THE END OF JULY



Council Tax Band: B - EPC Rating: E 53

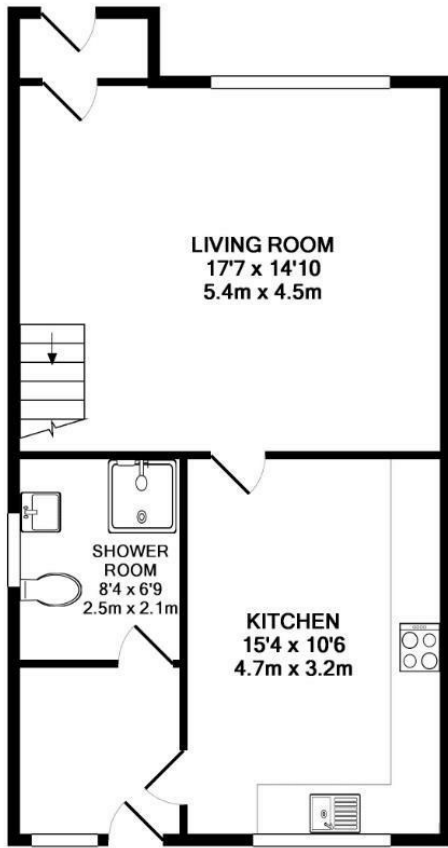

GROUND FLOOR

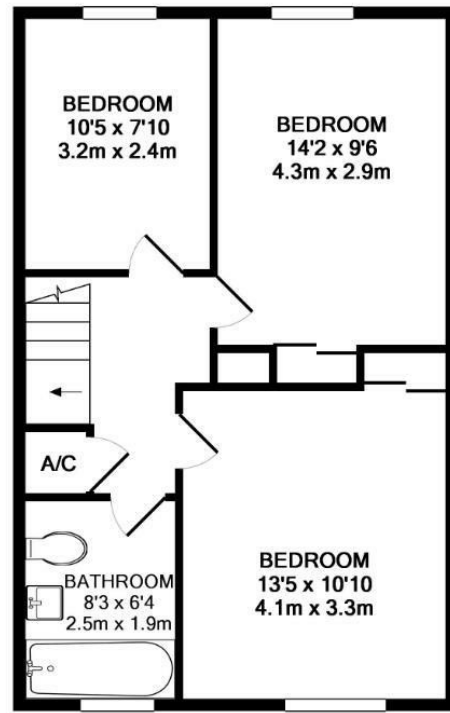

1ST FLOOR

Whilst every attempt has been made to ensure the accuracy of the floor plan contained here, measurements of doors, windows, rooms and any other items are approximate and no responsibility is taken for any error, omission, or mis-statement. This plan is for illustrative purposes only and should be used as such by any prospective purchaser. The services, systems and appliances shown have not been tested and no guarantee as to their operability or efficiency can be given
Made with Metropix ©2010

