



## Heathland Way, Mildenhall, Bury St Edmunds, IP28 7SF

Rent - £1,250 PCM      Deposit - £1,442

Shires Mildenhall are pleased to offer this spacious three bedroom semi-detached house in Mildenhall - close to RAF Mildenhall & Lakenheath. The property consists of entrance hallway, cloakroom, lounge, dining room, kitchen, en-suite shower room and bathroom. There is also air conditioning, front and rear gardens, garage and driveway. Available now, unfurnished.

- THREE BEDROOM SEMI-DETACHED HOUSE
- LOUNGE & DINING ROOM
- GARAGE & DRIVEWAY
- AIR CONDITIONED
- UNFURNISHED
- CLOSE TO RAF MILDENHALL & LAKENHEATH
- BATHROOM, EN-SUITE & CLOAKROOM
- FRONT & REAR GARDENS
- AVAILABLE NOW



Council Tax Band: C - EPC Rating: C 78



GROUND FLOOR  
418 sq.ft. (38.8 sq.m.) approx.



1ST FLOOR  
410 sq.ft. (38.1 sq.m.) approx.

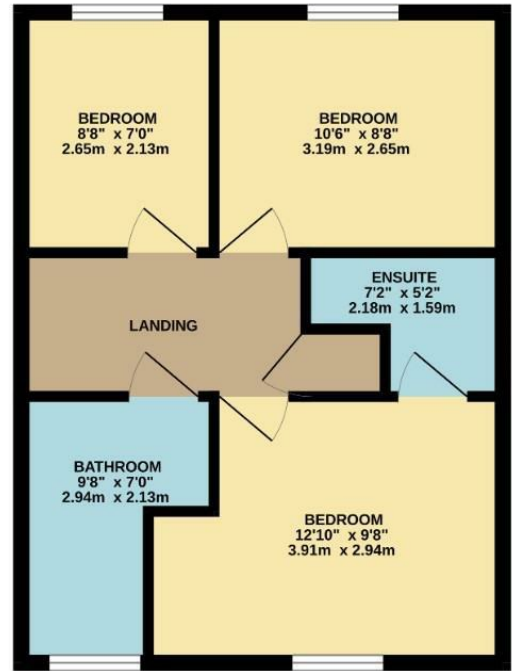

TOTAL FLOOR AREA : 828 sq.ft. (76.9 sq.m.) approx.

Whilst every attempt has been made to ensure the accuracy of the floorplan contained here, measurements of doors, windows, rooms and any other items are approximate and no responsibility is taken for any error, omission or mis-statement. This plan is for illustrative purposes only and should be used as such by any prospective purchaser. The services, systems and appliances shown have not been tested and no guarantee as to their operability or efficiency can be given.  
Made with Metropix ©2024

