



Coolidge Gardens, Cottenham, Cambridgeshire, CB24 8RH

A recently refurbished 1 bedroom first floor flat with the added advantage of having its own enclosed garden and parking to the front. The flat has its own entrance door which leads up to the first floor accommodation. The property is heated by a gas radiator system and has double glazing throughout. Call now to book your viewing before you miss out on this property.

- REFURBISHED 1 BEDROOM APARTMENT
- PARKING TO THE FRONT
- AVAILABLE MID MAY
- MODERN SHOWER ROOM
- ENCLOSED GARDEN
- PETS CONSIDERED
- FITTED KITCHEN
- VILLAGE LOCATION



GROUND FLOOR
528 sq.ft. (49.1 sq.m.) approx.

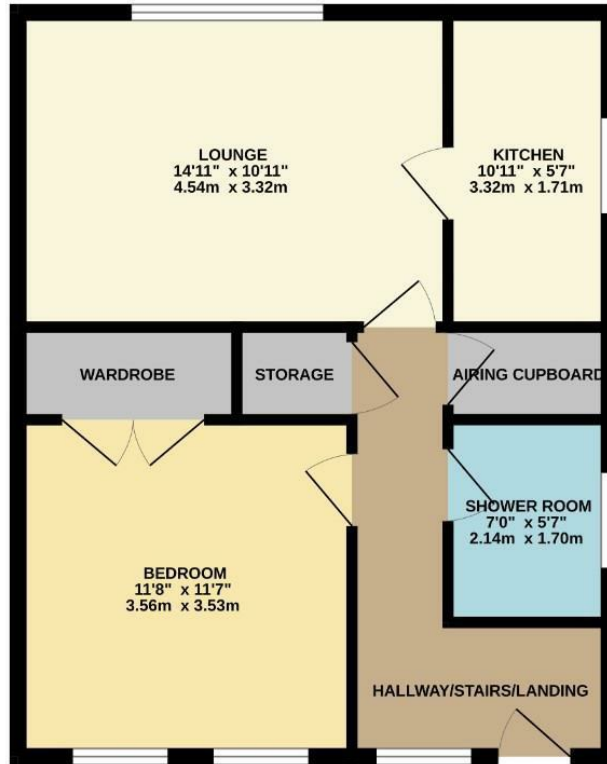

TOTAL FLOOR AREA : 528 sq ft. (49.1 sq.m.) approx.
Whilst every attempt has been made to ensure the accuracy of the floorplan contained here, measurements of doors, windows, rooms and any other items are approximate and no responsibility is taken for any error, omission or mis-statement. This plan is for illustrative purposes only and should be used as such by any prospective purchaser. The services, systems and appliances shown have not been tested and no guarantee as to their operability or efficiency can be given.
Made with MyHomeplan ©2024.

