



## North Terrace, Mildenhall, Suffolk, IP28 7AA

Rent - £750 PCM      Deposit - £865

This spacious 2 bedroom first floor flat is ideally located for the town and its amenities. The flat comprises of 2 double bedrooms, spacious living area, kitchen/breakfast room and a bathroom. There is space & plumbing for all of the needed white goods. Allocated parking space. Pets considered. EPC C.

- FIRST FLOOR FLAT
- 2 DOUBLE BEDROOMS
- SPACIOUS LOUNGE
- FAMILY BATHROOM
- ALLOCATED PARKING SPACE
- CLOSE TO THE TOWN CENTRE
- GAS HEATING & ENERGY RATING - C
- APPROXIMATE SIZE - 772 SQ FT
- PETS CONSIDERED
- AVAILABLE NOW!



Council Tax Band: A - EPC Rating: C 71

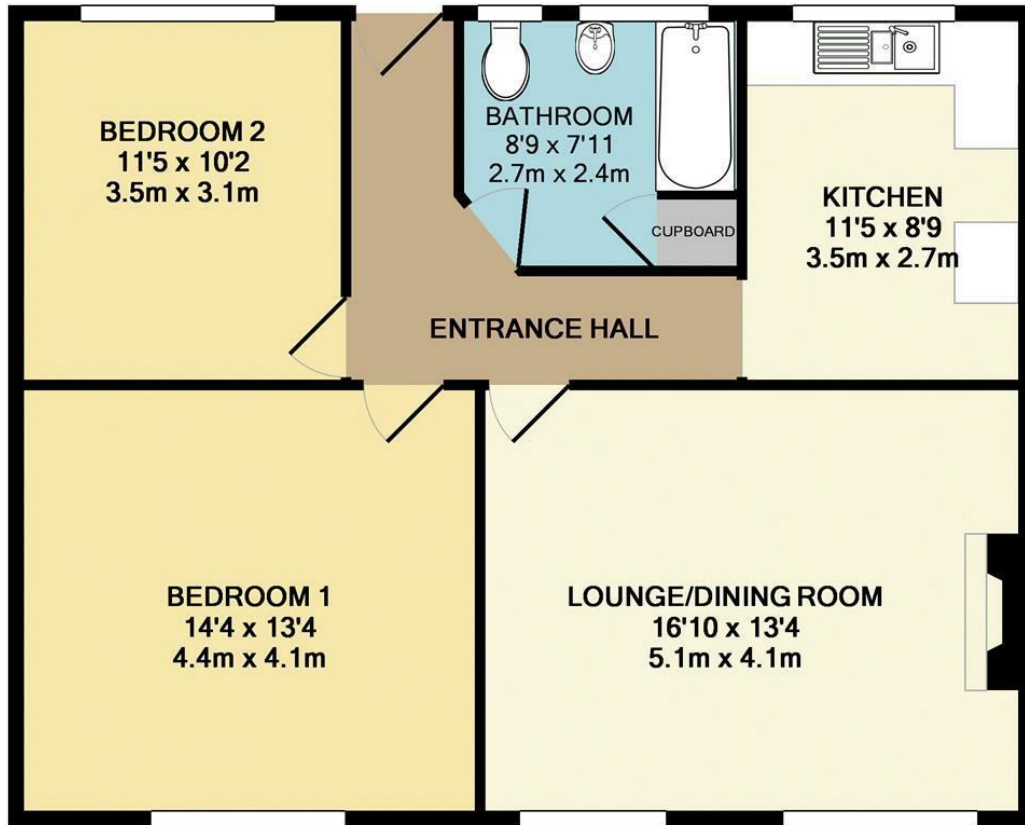

TOTAL APPROX. FLOOR AREA 772 SQ.FT. (71.7 SQ.M.)

Whilst every attempt has been made to ensure the accuracy of the floor plan contained here, measurements of doors, windows, rooms and any other items are approximate and no responsibility is taken for any error, omission, or mis-statement. This plan is for illustrative purposes only and should be used as such by any prospective purchaser. The services, systems and appliances shown have not been tested and no guarantee as to their operability or efficiency can be given  
Made with Metropix ©2019

