



## Peterhouse Close, Mildenhall, Suffolk, IP28 7NH

Rent - £1,100 PCM      Deposit - £1,269

Mid terraced house, 4 bedrooms with closets, pets considered, available immediately, EPC D, gas heating, enclosed garden, approximately 914 sq ft.

- MID TERRACED HOUSE
- LOUNGE/DINER
- GAS HEATING
- EPC - D
- APPROX. 914 SQ FT
- 4 BEDROOMS WITH CLOSETS
- KITCHEN
- ENCLOSED GARDEN
- PETS CONSIDERED
- AVAILABLE IMMEDIATELY



Council Tax Band: B - EPC Rating: D 66

**GROUND FLOOR**  
421 sq.ft. (39.1 sq.m.) approx.

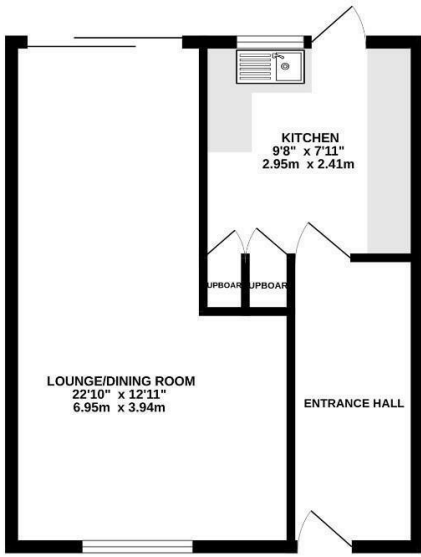

**1ST FLOOR**  
518 sq.ft. (48.1 sq.m.) approx.

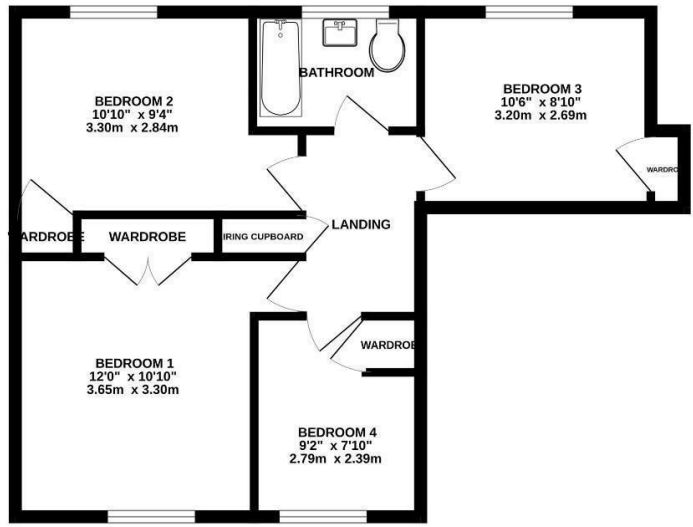

**TOTAL FLOOR AREA : 938 sq.ft. (87.2 sq.m.) approx.**

Whilst every attempt has been made to ensure the accuracy of the floorplan contained here, measurements of doors, windows, rooms and any other items are approximate and no responsibility is taken for any error, omission or mis-statement. This plan is for illustrative purposes only and should be used as such by any prospective purchaser. The services, systems and appliances shown have not been tested and no guarantee as to their operability or efficiency can be given.  
Made with Metropix ©2024

